

Technical and price proposal

Project : Takamaz ESL-10

Dear Client,

Thank you for your interest in our products. With reference to your inquiry we are pleased to present the following trade proposal.

According to the assumption - *"quality and components from Japan at the best prices"* - we would like to offer you the TAKAMAZ ESL-10 machine:

Machine	:	CNC TURNING LATHE
Product	:	TAKAMAZ
Model	:	ESL-10
Control	:	FANUC 0i-TF

Takamaz ESL-10



The photo presents the TAKAMAZ ESL-10 machine

MACHINE SPECIFICATIONS

Maximum turning diameter	Ø 180 mm
Maximum turning length	190 mm
Stroke of X axis	120 mm
Stroke of Z axis	230 mm
Rapid feed of X axis	12 m/min
Rapid feed of Z axis	18 m/min
Spindle drive power	5.5 / 3.7 kW
Drive power of X axis	AC 0.75 kW
Drive power of Z axis	AC 1.2 kW
Coolant pump	AC 0.25 kW
Hydraulic pump	AC 0.75 kW
L x W x H	1,450 x 1,295 x 1,650 mm
Weight	1.67 t
Current consumption	13 kVA

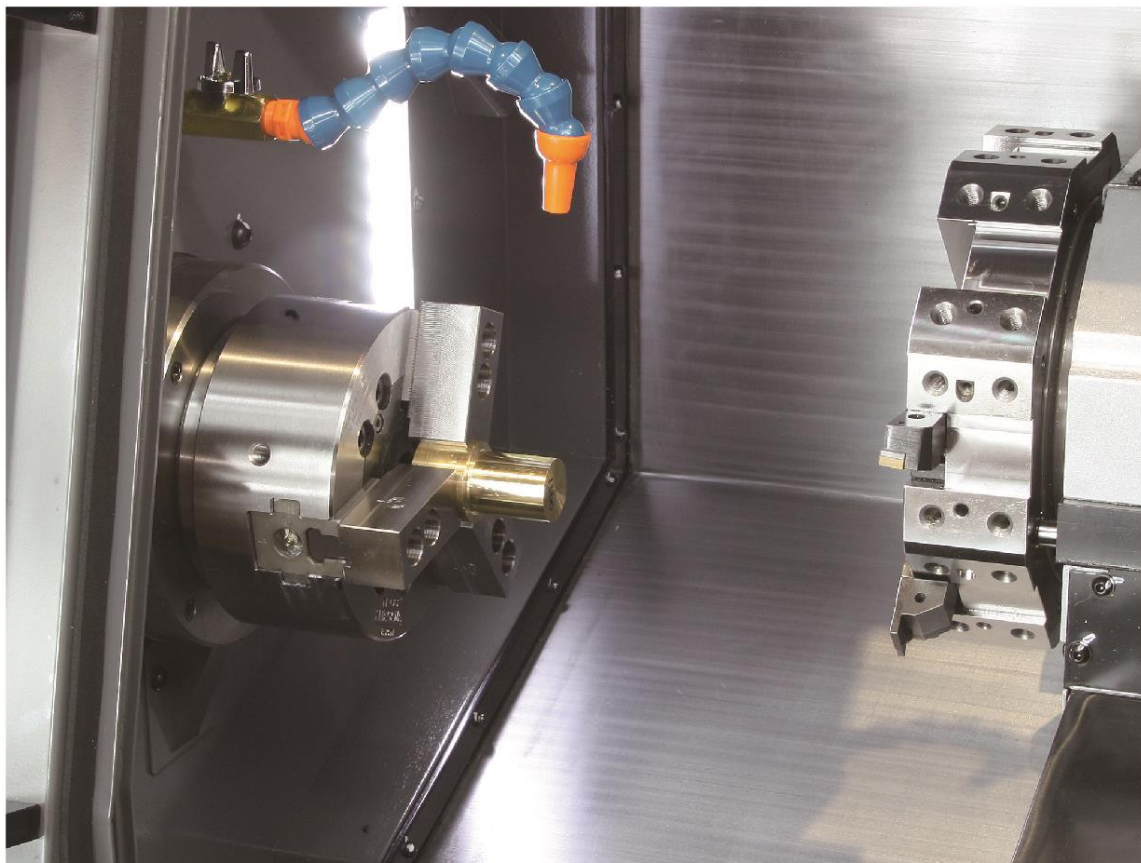

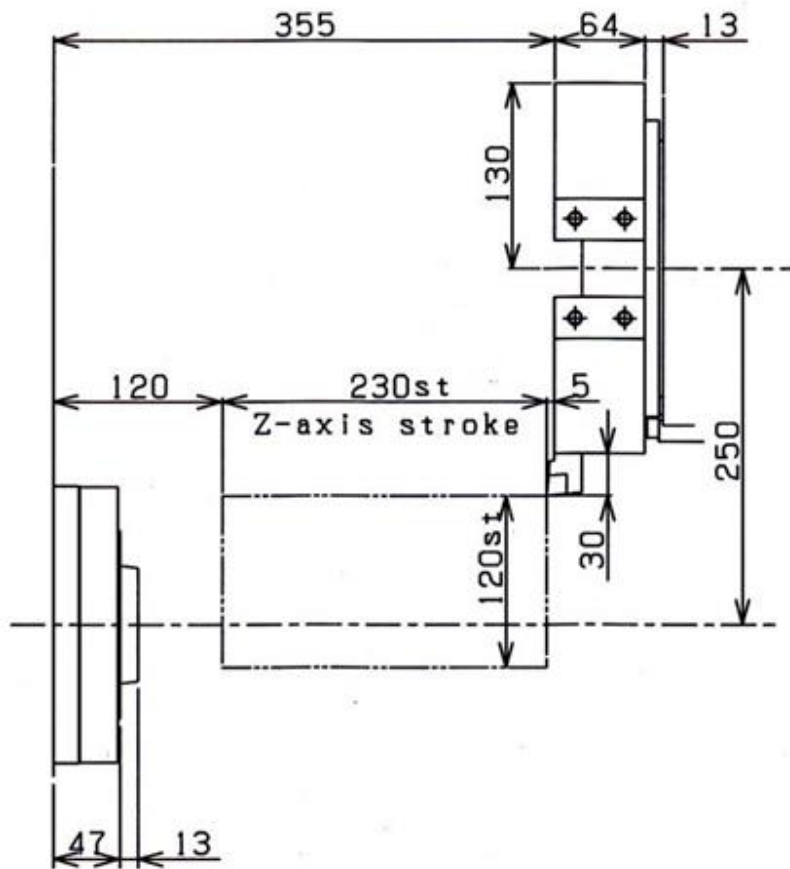

Spindle	
Spindle drive power	5.5 / 3.7 kW
Maximum spindle speed	4,500 min ⁻¹
Maximum torque	46.7 Nm
Spindle type	A2-5
Spindle bearing diameter	ø 75 mm
Spindle hole	ø 46 mm
Maximum diameter of bar (for ESL-10 B version)	ø 35 mm

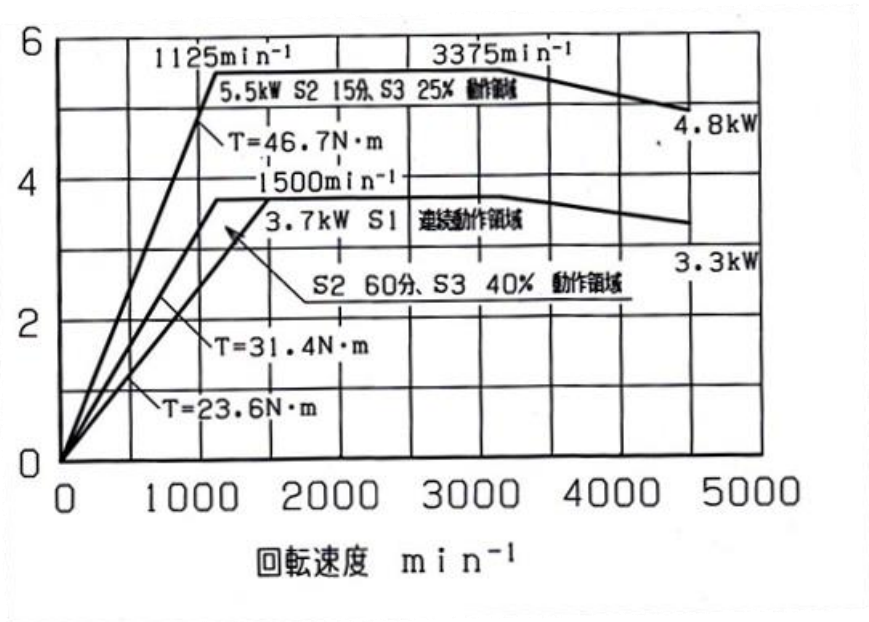

Turret tool	
Number of turrets	1
Type	Direct mounting
Number of tools in turret	8
Tool size	20 x 20 mm
Maximum boring bar diameter	φ 25 mm

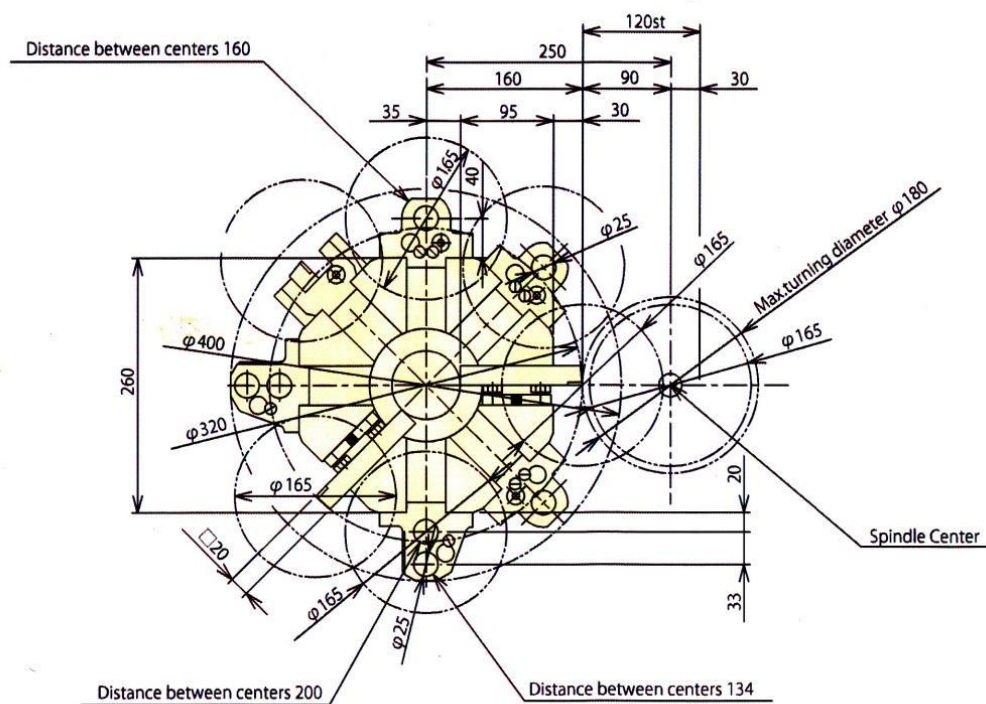

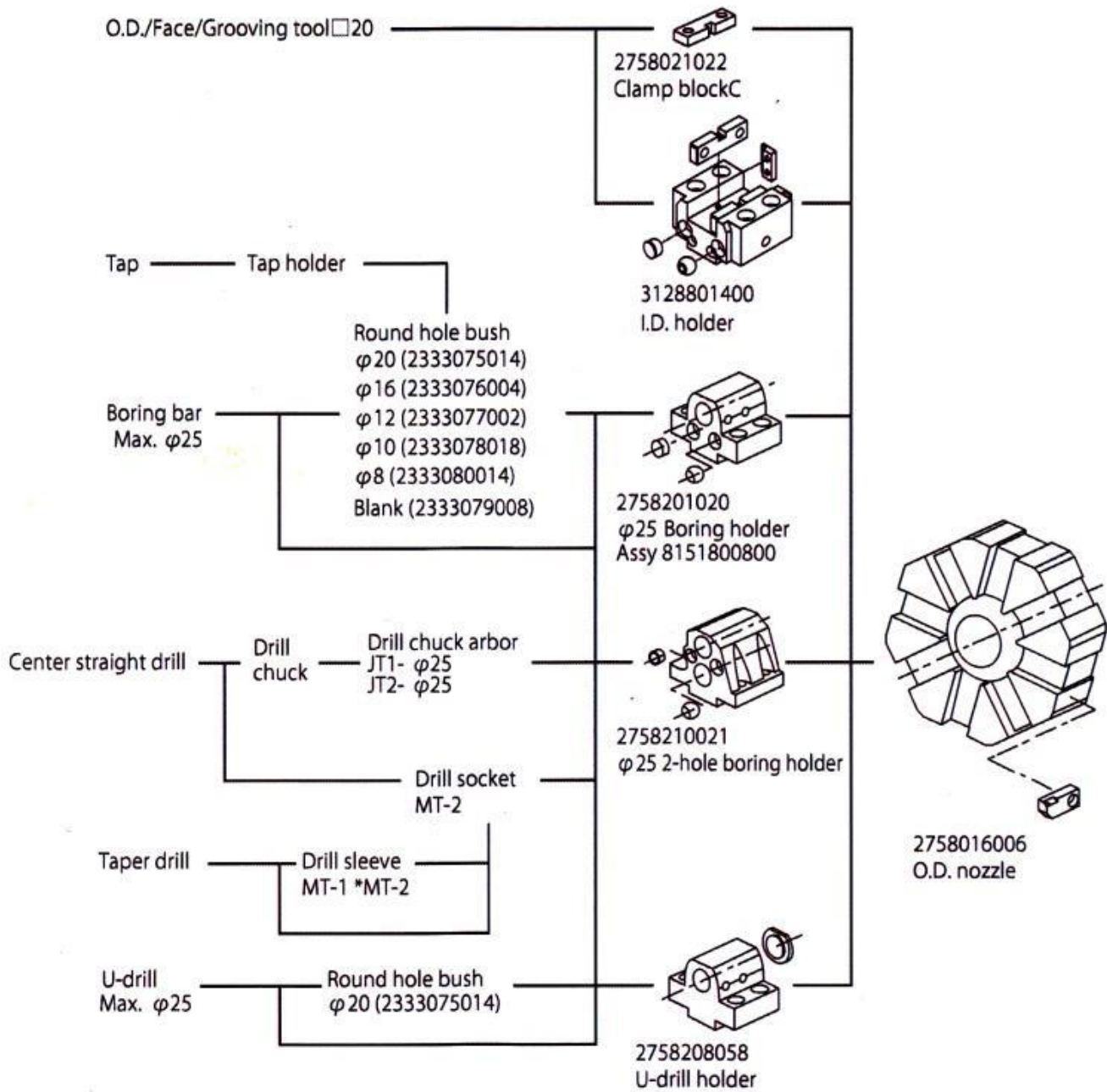

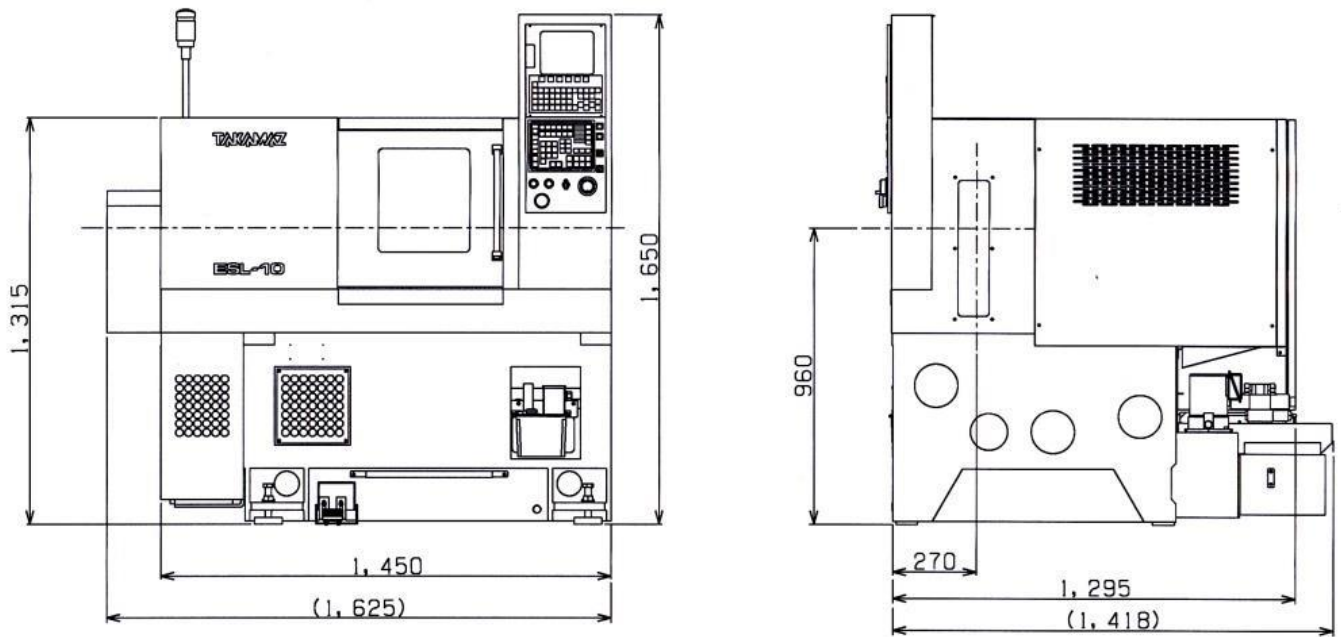

The figure shows ESL-10 without a chip conveyor and a transformer

Extensive basic equipment of the machine

- **Compact design.** The basic machine, electric control cabinet, cooling system, CNC control, control panel, and the workroom housing form a coherent unit on a very small area. Ergonomics, low center of gravity, operator-friendly and environmentally-friendly conditions, as well as the highest precision, and durability were taken into account when designing the unit.
- **The machine bed** has a strong rib structure. Diagonal reinforcing ribs prevent vibrations during the machining process and thermal deformations. The results include high rigidity and the best vibration damping properties.
- **Standard Tool Holders**
 - x8 sets of Clamp Block #2758021022
 - x2 sets of Boring Holder #2758201020
- X and Z axes have been equipped with perfectly sized, hardened and polished linear roller guides (made in Japan).
- **Ball screws** (made in Japan) are installed in all axes.
- **The spindle** has best-in-class bearings (made in Japan), and it has been designed to absorb forces radially and axially.
- **The optimum chip drop and easily accessible workspace** have been achieved by placing the spindle directly above the chip container.
- **Hydraulic pump unit**
- **Hydraulic cylinder for the holder**
 - ESL-10 A with solid cylinder SMW SIN-S100
 - ESL-10 B with hollow cylinder SMW VNK70-37
- **FANUC 0i-TF control** with an 8-inch LCD screen.
- **Standard coolant pump**
- **Levelling plates**
- **Electrical control cabinet**, fan cooled.
- **CE conformity**

Select the equipment for your machine!

ESL-10 A with chuck work

ESL-10 B with bar (Max Ø35 mm, Max Length 800mm)

ESL-10 A	With chucks Warranty: 12 months	38.600,-€	
ESL-10 B	With bar Warranty: 12 months	41.100,-€	
option	Solid chuck SMW AMD 165 A5	1.753,-€	
option	Solid chuck Kitagawa N06 A5	1.344,-€	
option	Hollow chuck SMW BHD 165 A5	1.668,-€	
option	Hollow chuck Kitagawa B 206 A5	1.758,-€	
option	Collet chuck SMW KSZ MB 40 A5 (173E)	820,-€	
option	Chip conveyor – spiral type	2.100,-€	
option	15 kVA transformer	800,-€	
option	Transport		
option	Installation	500,-€	
option	1 day of training	500,-€	
Extension warranty option	Takamaz Warranty: 24 months (after installation)	1.000,-€	
option	Fanuc Warranty: 24 months (after installation)	980,-€	
For type B option	Parts catcher	2.700,-€	
For type B option	Bar feeder 1.5m BS 65 Servo (additional elements of the feeder and installation are not included)	8.240.-€	
3128801400 option	I.D. Holder	295.-€/St.	
2758201020 option	Ø25 Boring Holder	345.-€/St.	
2758210021 option	Ø25 2-hole Boring Holder	425.-€/St.	
2758208058 option	U-drill Holder	415.-€/St.	

(All prices excluding VAT)

Terms of sale and payment

Cost valuation

FCA Incoterms 2010 seaport of Antwerp or one of our warehouses.
All prices are net prices exclusive of VAT.

Delivery time

ESL-10 A Delivery time from May 2016.
ESL-10 B Delivery time from June 2016.

Delivery

Delivery of the machine is carried out in accordance with the general terms and conditions (GTC) of our sales network

Terms of payment

to be discussed

Technical data

The presented technical data is not binding and must be confirmed if an order is made. The manufacturer reserves the right to make any changes in the data.

Warranty

Under the general terms and conditions the warranty period begins when the machine is collected by the buyer.
The warranty does not include wear parts and damage caused by incorrect machine operation.
FANUC warranty is not include in machine price.

Proposal validity

This proposal is not binding. The prices shall be valid for a period of four weeks from the date of issue.

Other

Unless otherwise specified the general terms and conditions shall apply.
Additional arrangements must be made in writing.

Your partner in machining and automation solutions

"Efficient production at our clients' premises is our top priority!"

The production technology faces different challenges. New materials and the highest quality standards generate stricter and stricter requirements for modern production techniques. Globalization of markets and shortening delivery times increase the pressure on costs and flexibility in production. Our sales network and its entire team face these challenges and implement innovative solutions.

System integration

With our extensive expertise in the field of machining technology from the measurement technique to complex automation we can develop and implement individual and technically advanced production solutions together with our clients.

Our sales network develops the concept of production that is based on a thorough analysis of your requirements and technical capabilities.

Balanced automation

We also offer extensive consulting services in terms of automation. What was an innovative technological requirement yesterday may already be outdated today. Not everything that looks like the latest technology would be the best solution for your individual production concepts. Automation must be matched to your requirements. Our sales network automates not only machines of its suppliers but also machines and production equipment from any other manufacturers.

Our services:

- ✓ Interdisciplinary process development
- ✓ Automation and combining of processes
- ✓ Delivery of complete and individual production systems
- ✓ Support in line with the "comprehensive service from a single supplier/manufacturer" principle
- ✓ Comprehensive consulting and after-sales services