

ELEMATIC



**Elematic
makes your
dream concrete**



We make your dream concrete



A world of precasting solutions

Precast technology is profitable, especially with Elematic

Precast concrete is increasingly popular because it makes construction highly productive. With our technology, precast elements are highly efficient for producing both large and small volumes, and for installation on-site.

Living originality

Precast concrete is all around us. You will find it almost everywhere you go, from high-rise apartments and luxury resorts to bridges and railway sleepers. In these and so many other uses, precast makes it possible for us to enjoy our lives and go about our business.

Yet precast can surprise you. A building that has the appearance of marble or brickwork may well have been made of precast. Indeed, precasting technology has



developed immensely over the years, and today enables us to produce durable, versatile building products that are both practical and beautiful.



When looking for a precast technology partner, Elematic is the right choice. Our technologies ensure that your elements will be durable, flexible enough to meet special requirements, and have accurate specifications.

This is the Elematic mission. You dream it – we make it concrete.

- *Elematic offers a variety of technologies for the construction of single-family houses like these – their appearance proves just how versatile precast concrete can be.*



All the things you can do with precast and Elematic:

apartment buildings, industrial complexes, railway sleepers...



• *The one-stop-supplier for precasters: Elematic is a global leader in precasting technology for a whole range of applications – from luxury hotels and apartment complexes to commercial sites and infrastructure. Elematic solutions are currently in use in more than 100 countries worldwide.*





The elements of success

Complete factories wherever you wish

Elematic has been known for decades as the leading supplier of complete plants, machinery and equipment worldwide. As a result of our experience in over 100 countries, from Barbados to China and beyond, we have the proven capability and required resources to deliver complete precast factories anywhere in the world.

• Infrastructure



• Railway sleepers



We offer the entire precasting palette

We offer solutions for the manufacture of all types of precast elements, whether your needs cover a single machine or an entire production plant. Many of these solutions are standard, but we can also meet a wide range of customized requirements.

As the one-stop-supplier for all precasters, our capability covers the entire production process from concrete batching to storage yard management and beyond. In addition to state-of-the-art machinery, we offer comprehensive consultation, service and support, as well as extensive production software and spare and wear part availability.

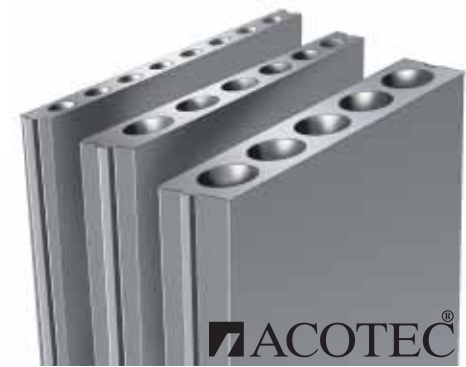

• Acotec partition walls

ACOTEC®

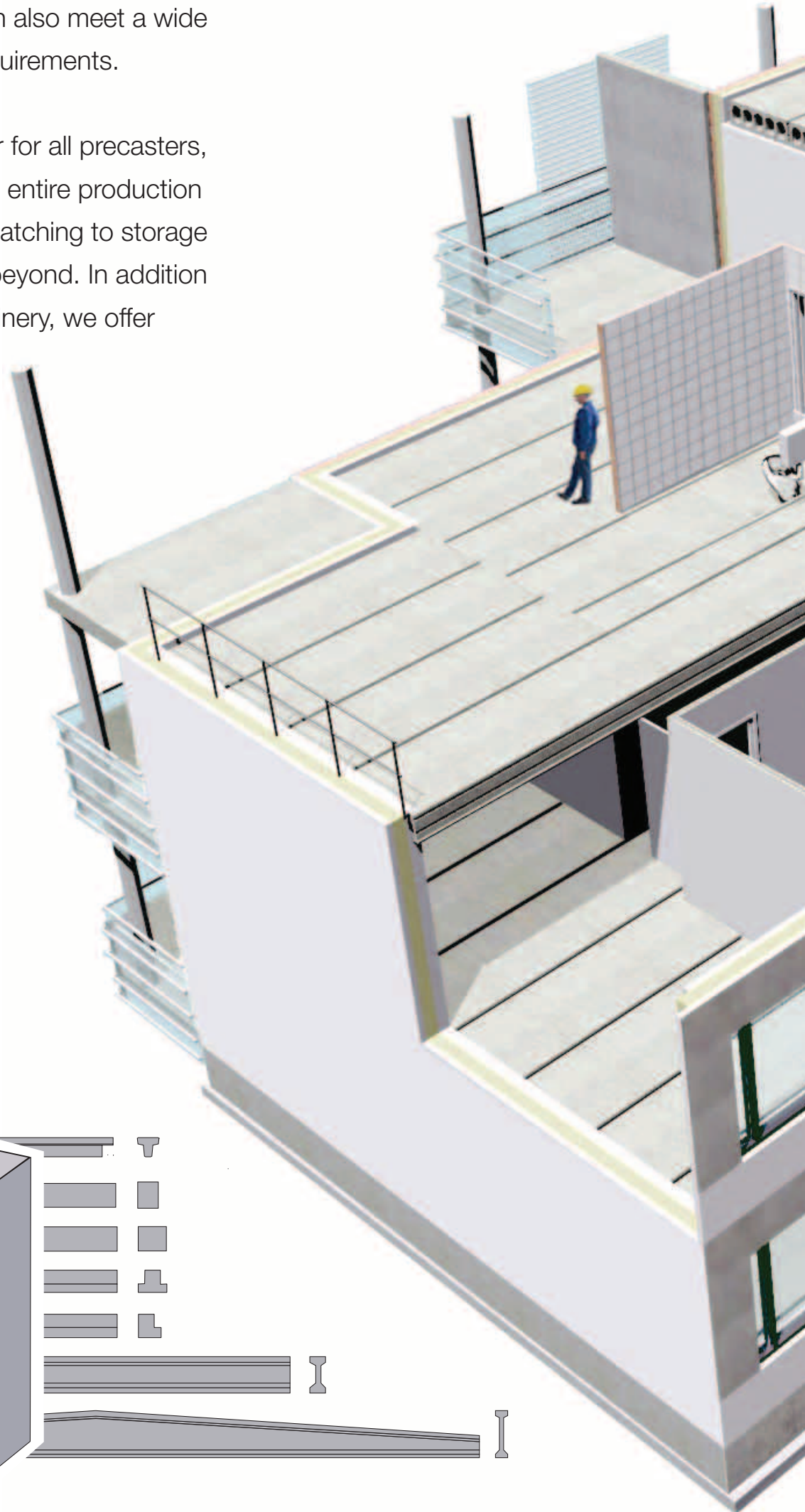

• Beams and columns

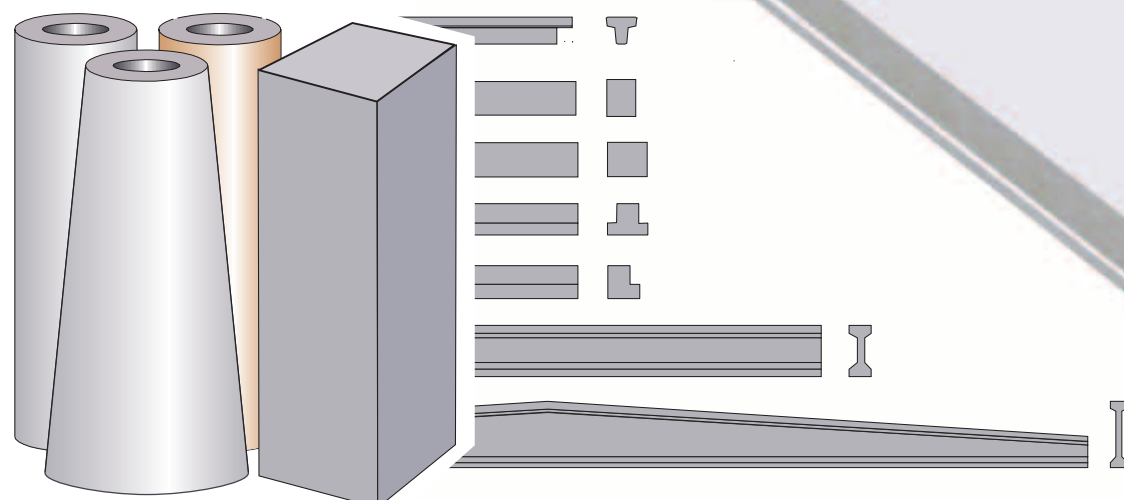

- Precast offers a fast, exact, versatile and environmentally-friendly way to build – ideal for infrastructure, commerce and residential uses alike. It also makes long spans possible and ensures a high fire-rating, resulting in reduced insurance premiums and better overall economy.

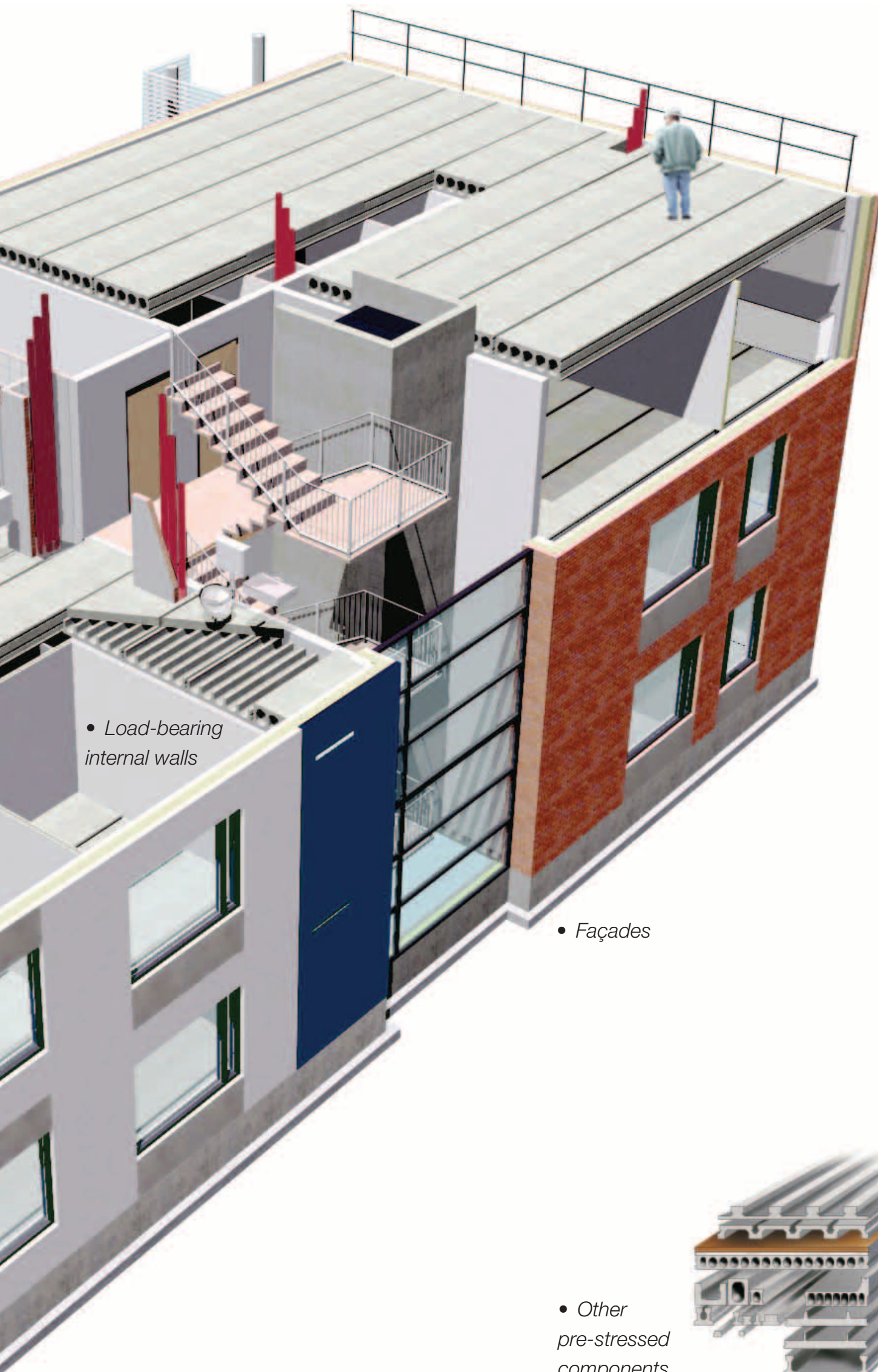

• Load-bearing internal walls

• Façades

• Other pre-stressed components



• Hollow-core slabs

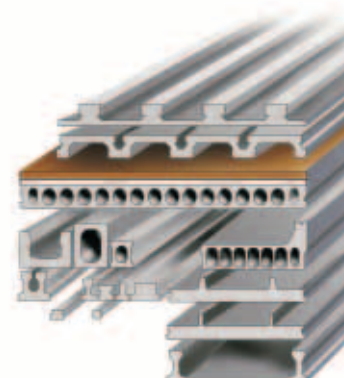

Elematic offers solutions for:

Housing and industrial construction

- façades
- floors
- partition walls
- beams, columns and solid floors
- tailored solutions

Infrastructure construction

- sound barriers
- bridge beams
- railway sleepers
- retaining walls
- tailored solutions

Software and automation

- enterprise resource planning software (ERP)
- control systems for batching and mixing plants
- production line automation systems

Auxiliary operations

- process waste recycling
- service and support
- spare and wear parts



We're with you every step of the way

Full service and support

Our comprehensive service and support covers the entire precast concrete production process, from production planning to machinery operation and support. You will also benefit from maintenance services that we can provide either remotely via the internet, or through site visits by one of our specialists.

Yet service and support cannot be complete without comprehensive spare and wear part availability. Our Customer Service Center stocks more than 4,000 items, with immediate availability of the most common parts. We deliver these to anywhere in the world with speed and efficiency.

- *Mixing equipment*



Partnership from start to finish

When you team up with Elematic, you get much more than state-of-the-art equipment. It is our mission to be your partner throughout the lifetime of your process, whether it involves a single machine, production line or complete factory. To this end you will have the full support of our expert staff starting from consultation and planning through to maintenance and training services.

- *Our position as a one-stop-supplier brings many benefits. These include synchronized production and an automation level tailored to your needs.*



- *Batching and mixing plants*

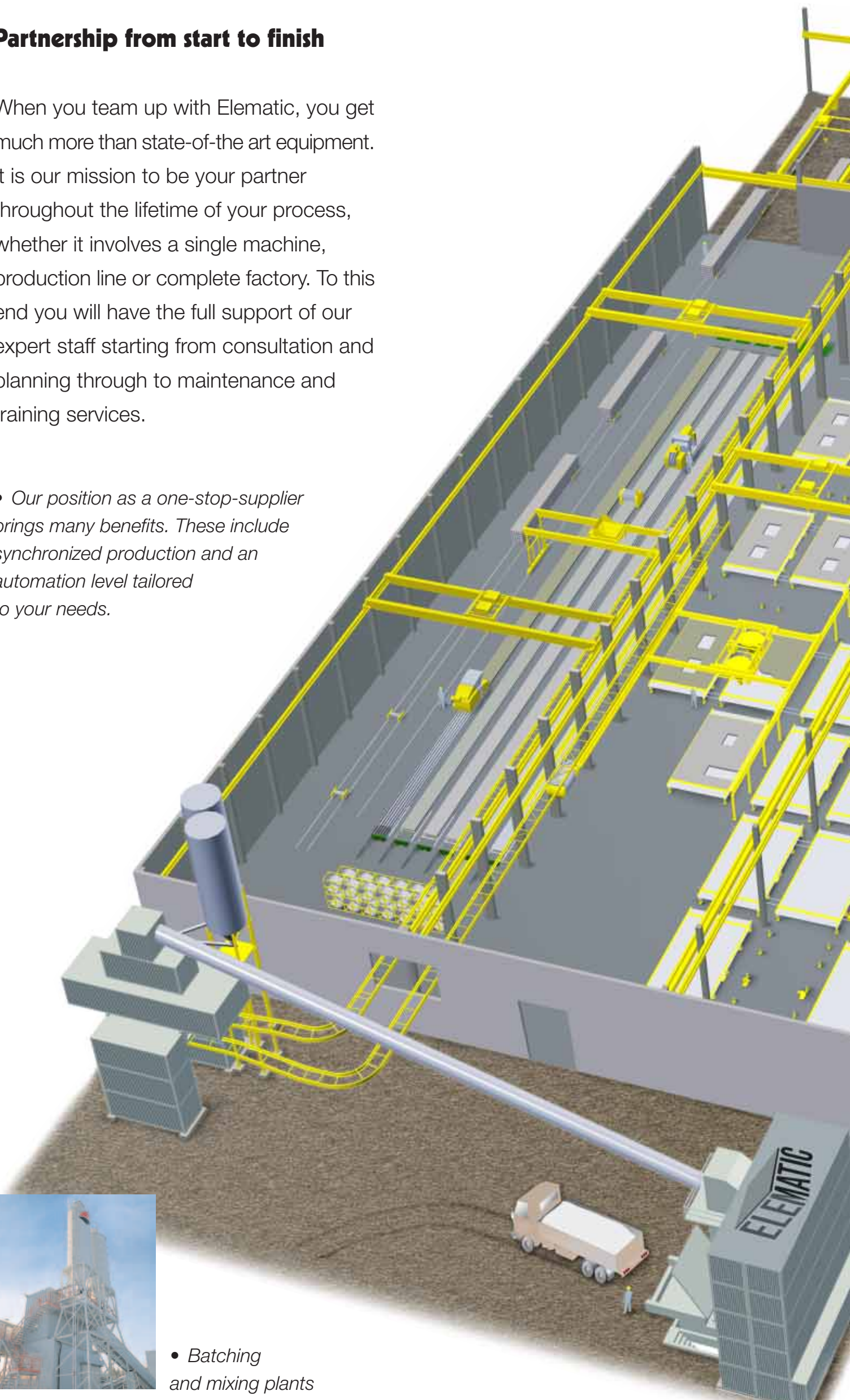

- Elematic offers several technologies for the production of sophisticated façades and other walls – including circulating lines, tilting tables and battery molds.

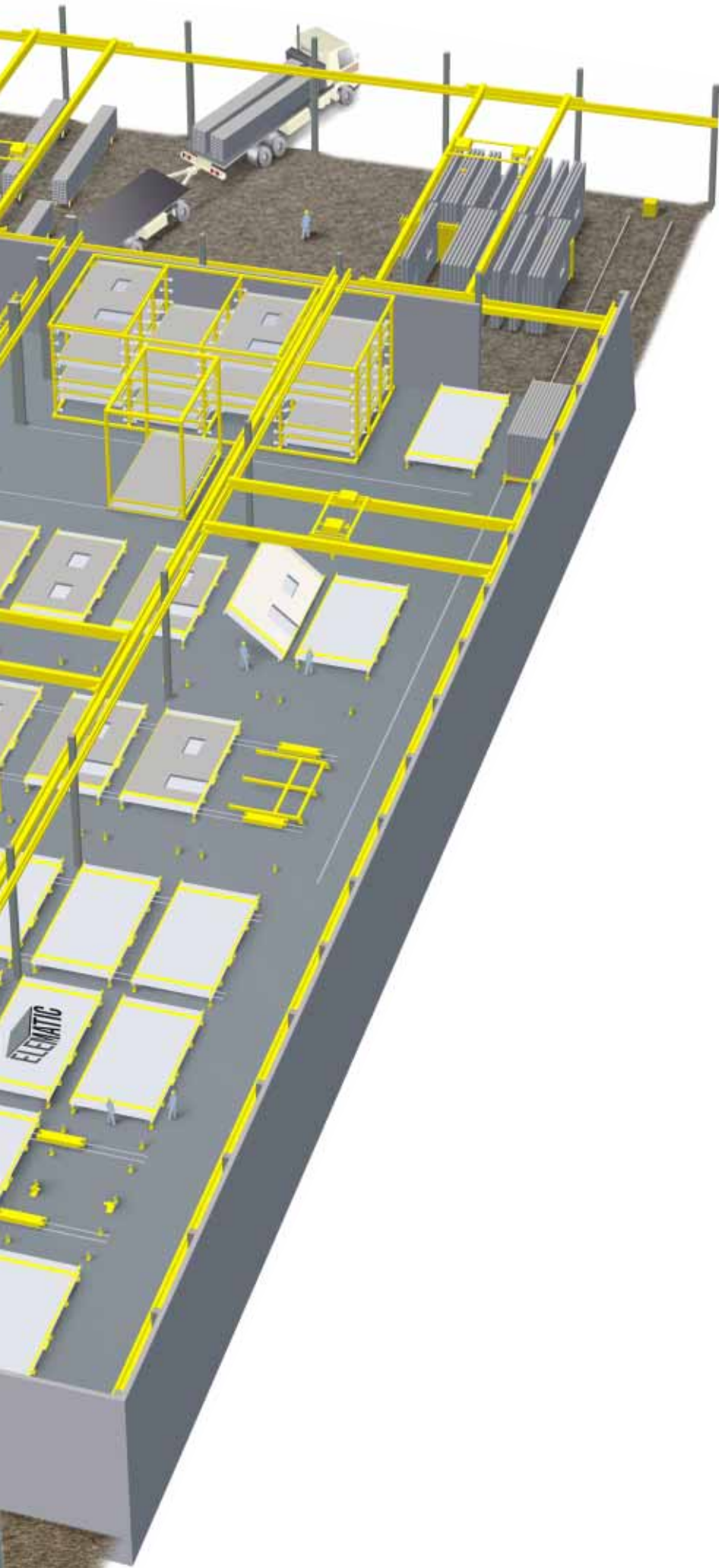

- The Elematic fastening method™: magnets and side forms



- Bedmaster for cleaning, oiling, pulling strands etc.



- Shuttles for concrete distribution and extruders for pre-stressed hollow-core slab and wall production.

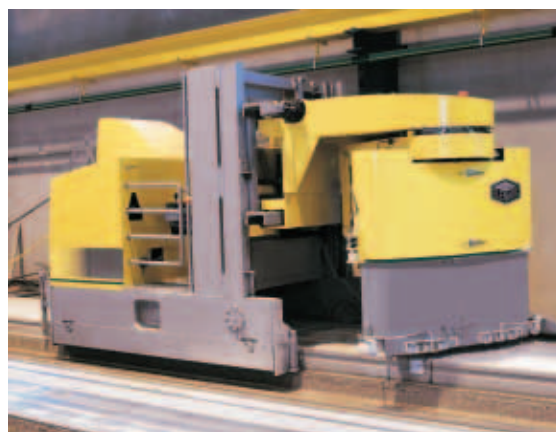

- Saws and fixed sawing stations



- Plotters

- Slipformers for the production of various pre-stressed elements: from hollow-core slabs to beams, columns, vineyard posts and other special components.



Elematic is with you throughout the precasting process:

- planning • batching • mixing • distributing • casting
- lifting • curing • automation and software
- service and support • spare and wear parts
- consultation and training



Elematic is a leading supplier of precast concrete machinery and equipment as well as the only supplier capable of delivering complete production plants anywhere in the world. Elematic's superior technology and industry expertise is currently in use in more than 100 countries across five continents. Elematic is headquartered in Toijala, Finland.

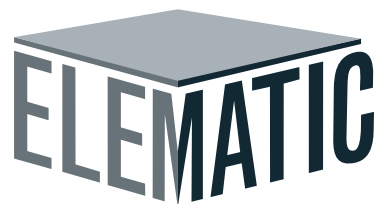

www.elematic.com

Finland

Elematic Oy Ab
Aiolantie 2
P.O. Box 33
37801 Toijala
Finland
Tel. +358-3-549 511
Fax. +358-3-549 5300
E-mail:
info@elematic.com

Germany

Elematic GmbH
Kleebergstrasse 1
63667 Nidda
Germany
Tel. +49-6043-9618 0
Fax. +49-6043-6218
E-mail:
info@elematic-gmbh.com

USA

Elematic Inc.
21795 Doral Road
Waukesha, WI 53186
USA
Tel. +1-262-798 9777
Fax. +1-262-798 9776
E-mail:
info@elematic-inc.com

United Arab Emirates

Elematic Dubai
Apt. 3506, Murjan Tower
Dubai Marina
P.O.Box 48748
Dubai
Tel. +971-50-7588 395
E-mail:
dubai@elematic.com