

PROXXON

*Tools with
Character!*



*2007/2008
Includes many new items.*

Manufactured in the world's largest socket and spanner factory, utilising the most modern production techniques.

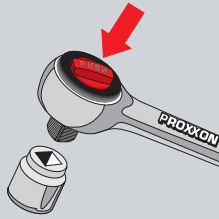
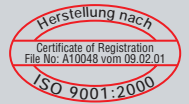

Quick release button releases socket instantly:

A feature you will appreciate every day.



Quality at its best:

Highest quality, exceeds DIN/ISO requirements for hardness and maximum torque. Individual size tolerances are all well within the prescribed norms.

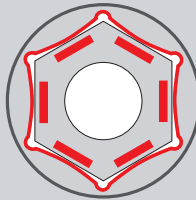

The PROXXON driver system:

The driving force is transferred to the sides of the nut or bolt, not the corners. This ensures high power transfer without damaging the corners of the nut or bolt.

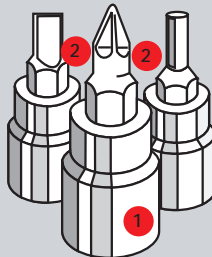

Screwdriver bits:

With CrV socket ①. The drive bits are all an optimum combination of chrome-silicon manganese-molybdenum steel ②.

All bits and accessories are forged using 31CrV steel. High carbon content to ensure consistent hardness. ③

Deep, uniform forging is fully guaranteed on the hex. drive side ④ to ensure that protruding studs do not present a problem. Thin-wall construction ⑤ for better access while maintain strength for heavy work. Lead-in chamfer ⑥ allows socket to slide over nuts easily. Machined fits on drive square ⑦ allow ratchet to arrest properly. Beginning with the 19mm size the outer diameter of the sockets is reduced on the drive square end for improved handling ⑧. Double nickel-plating and single chrome-plated finish provide optimum surface protection.

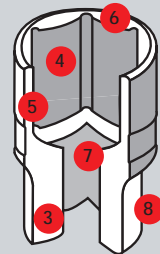

Inseparable handle of oil and acid-resistant NEOPRENE. With hole for hanging.



Socket sizes easy to read due to laser marking!

2 year guarantee

For full professional use!

Sockets and drive elements carry an additional 25 year guarantee against faulty material and workmanship.



The heart of a socket set: The ratchet.

With push button socket release.



The Ratchet:
is made from one single piece, i.e. the head is not welded on ① .
Quick release button releases socket instantly when pressed ② .
Perfect teeth, suitably hardened for maximum life expectancy ③ .
Reliable drive direction mechanism simultaneously engages numerous teeth to ensure optimal torque transmission ④ .



The appropriate tightening torque and socket size are indicated in the table of bolt diameters (1.6 to 24mm), located in the lid of all socket sets shown on the right.



NO 23 000

The welded steel box is strong and powder coated for durability. The strong moulded plastic insert provides a secure location for each item.

Inseparable handle of oil and acid-resistant NEOPRENE. With hole for hanging.

The ratchet is supplied in all the sets shown on the right except for 23 100, 23 102 and 23 072.



Socket sets in chrome vanadium steel.

Standard range in sturdy, powder coated steel boxes.



For mechanics who need power, the 29 piece set, with 8 to 34mm sockets.

For/with 1/2" square drive, with 34mm socket (the 21mm socket complies with the new ISO standard). Deep sockets for protruding bolts. 16 and 21mm spark plug sockets. See photo for full contents.

NO 23 000



56 piece set with 1/4" and 1/2" ratchets.

Contains sockets from 4mm to 32mm and 16/21mm spark plug sockets, screwdriver bits with square drive for slotted, Phillips, TORX (with leading edge indentation for easy positioning) and Allen sockets and 1.25 - 1.5 - 2.0 - 2.5 and 3mm Allen keys.

See photo for full contents.

NO 23 040



Automotive socket set with 1/4" and 1/2" ratchets, 27 piece set.

Suitable for all common sizes between 6mm and 32mm. Also contains 16 and 21mm spark plug sockets.

See photo for full contents.

NO 23 020



Compact set with 3/8" drive for 6 - 24mm sockets, 24 pieces.

Set includes 16, 18 and 21mm spark plug sockets.

See photo for full contents.

NO 23 110

High quality tools for industry,

workshop and construction at a really great price.

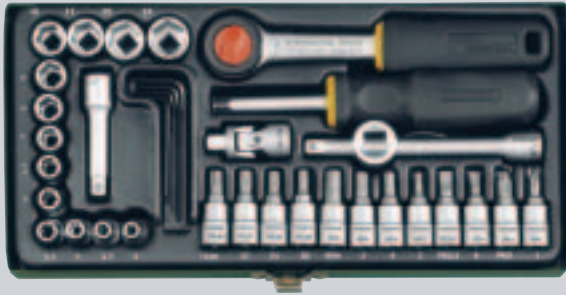

Precision engineer's set with 1/4" square drive, 36 piece set.

Includes 4 – 13mm sockets, screwdriver bits with square drive for slotted, Phillips and Allen sockets and 1.25 – 1.5 – 2.0 – 2.5 and 3mm Allen keys. Just compare the value for money.
[See photo for full contents.](#)

NO 23 080

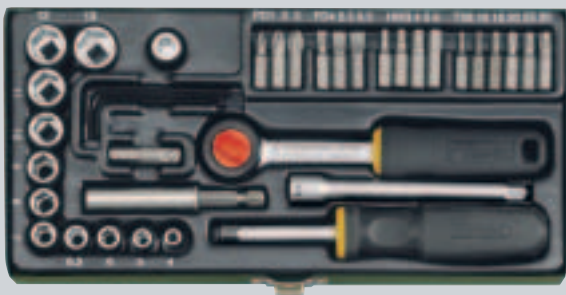

38 piece screwdriver/socket set with magnetic adapter.

For use with a drilling machine: 4 – 13mm sockets (1/4" drive). Includes 16 high quality alloy Allen key bits and adapters for male hex and square bits (magnet to socket adapter) and female hex and square bits (ratchet to screwdriver bit adapter) and 1.25 – 1.5 – 2.0 – 2.5 and 3mm Allen keys.
[See photo for full contents.](#)

NO 23 070



23 piece TORX socket set.

This set contains 1/4" drive TORX sockets in sizes TX8 to TX30 and external TORX sizes E4 to E8 (all suitable for drive torques up to 10Nm), 1/2" drive TORX sockets in sizes TX40 – 60 and external TORX E10 to E18 (for torques from 25 to 135Nm) and three offset TORX spanners – the TX6, 8 and 10.
[See photo for full contents.](#)

NO 23 102



NEW

Compact Screwdriver set of 26 pieces with 1/4" drive. Suitable for all bikers.

The square drive end of the handle drives the sockets without an adapter. An adapter also facilitates the use of standard bits. The rear of the handle is supplied with a square hole, accepting the extension as additional lever. The bits are all of high quality special steel and the TX items are fitted with a leading edge indentation.
[See photo for full contents.](#)

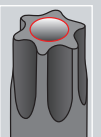

NO 23 072



18 piece Allen key socket set.

This 18 piece set offers 1/4" drive for torques to 10Nm in sizes 2 – 6mm. The 1/2" drive offers torques of 25 – 210Nm in sizes 6 – 14mm (in short version of 55mm) and 5 – 12mm (in long version of 100mm)
[See photo for full contents.](#)

NO 23 100

Note: Our super safety and specialty bit set (75-piece) is described in detail on page 20 of this catalogue.

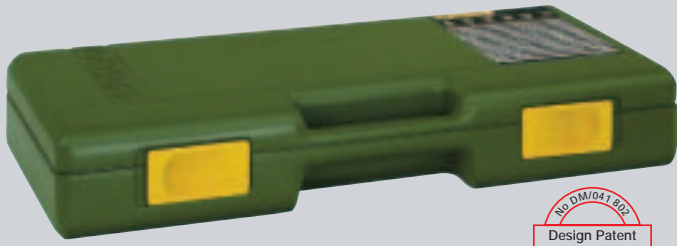

Composition and design copyright by PROXXON.

High strength plastic case with secure sliding locks for easy opening and closing. Each part embossed with size or symbol. A helpful thread table is on cover.

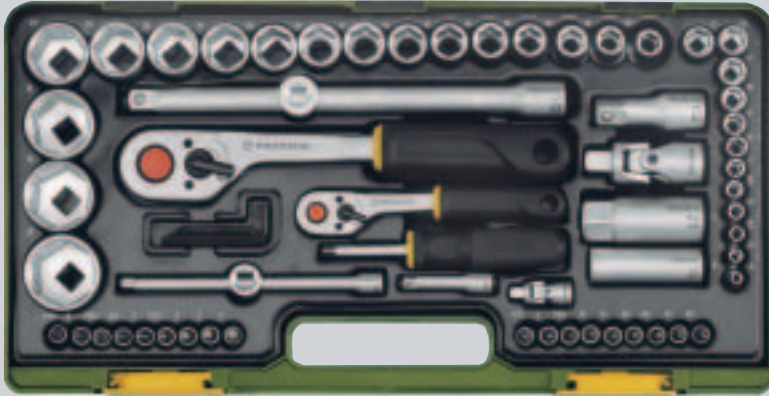

Complete set with S and L baton ratchets (1/4" and 1/2").

This 65 piece set offers sockets from 4 to 34mm, as well as 16 and 21mm spark plug sockets. Screwdriver bits with square driver for slotted, Phillips, TORX and Allen sockets. Allen keys 1.25 – 1.5 – 2.0 – 2.5 and 3mm. Four extensions, one screwdriver handle with square drive, two universal joints. Screwdriver handle with square drive for slotted, Phillips, TORX and Allen sockets.
See photo for full contents.

NO 23 286

Imperial set with general contents as above.

Sockets from 5/32" – 1 3/8". Spark plug sockets for 5/8" and 13/16". Screwdriver bits with square drive for hex 1/8" – 1/4" bits, TX, Phillips and flat. Allen keys in 0.05", 1/16", 5/64", 3/32" and 1/8".
All other details as per NO 23 286 above.
NO 23 294



Compact set with baton ratchet M (3/8").

This 44 piece set offers sockets from 6 – 24mm. Deep sockets 10 – 17mm for protruding bolts. Spark plug sockets for 16, 18 and 21mm, T-bar and two extensions. Screwdriver bits with square drive for Allen screws 4 – 10mm and TORX screws (20 – 40). Five Allen keys 1.25 – 1.5 – 2.0 – 2.5 and 3mm.
See photo for full contents.

NO 23 282

Special 36 piece set for TORX screws, complete with FELO screwdrivers.

With 1/4" square drive (for torques under 25Nm). Screwdriver bits for TX8 and TX40 (all tamper-resistant with indentation in end for use with TORX safety screws). For male TORX screws (E4 – E10) normal version (25mm), as well as E8 and E10 long version (50mm) for deep set bolts.
With 1/2" square drive (for torques over 2Nm), screwdriver bits TX45 – TX60 short version (55mm) and also long version (100mm) for male TORX screws E12 – E24 short version (40mm) as well as E12, E14 and E16 long version (80mm) for deep set bolts. Also included: FELO screwdrivers for TX8 – TX25.
See photo for full contents.

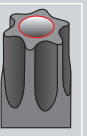

NO 23 288

Heart of the PROXXON INDUSTRIAL socket sets.

Baton ratchets.

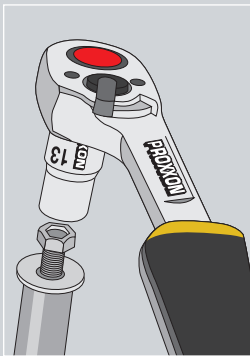

**2 YEAR
GUARANTEE**

For full professional use!

Sockets and drive elements carry an additional **25 year guarantee** against faulty material and workmanship.

Asymmetrical shape improves view when attaching to nut or bolt head.



Quick-release button releases socket instantly.

Perfect teeth, suitably hardened for maximum life expectancy. Reliable drive direction mechanism simultaneously engages numerous teeth to ensure optimal torque.



20 piece special socket set with deep sockets.



With a 1/4" square drive (for torques under 25Nm), hexagonal sockets for 4 - 5 - 5.5 - 6 - 7 - 8 - 9 - 10 - 11 and 12mm.

With a 1/2" square drive (for torques over 25Nm): 13 - 14 - 15 - 16 - 17 - 18 - 19 - 20 - 21 - 22 and 24mm. All parts are matt chrome-plated and are clearly labelled.

See photo for full contents.

NO 23 292

49 piece precision engineer's set with baton ratchet S (1/4").

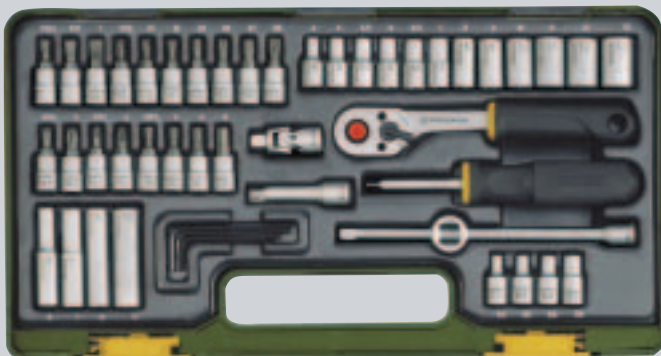

This set includes sockets from 4 - 13mm, deep sockets from 6 - 10mm for protruding bolts and screwdriver bits with square drive for slotted, Phillips, Allen and TORX screws. It also has external TORX sizes 4 - 8, T-bar, 2 extensions, screwdriver handle with square drive and 1.25 - 1.5 - 2.0 - 2.5 and 3mm Allen keys.

See photo for full contents.

NO 23 280

41 piece special set for TORX and Allen screws.

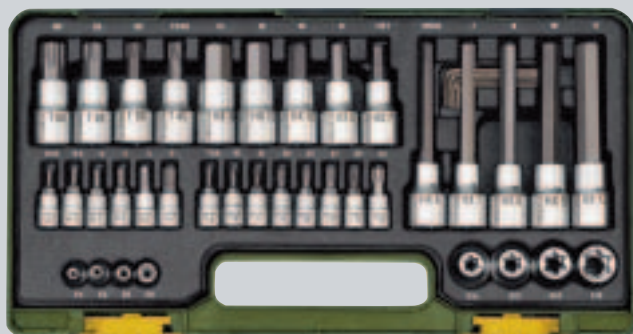

This set offers a 1/4" drive for torques below 25Nm.

Screwdriver bits, Allen key screws from 2 - 6mm, TORX sockets for sizes 8 to 40 and external TORX E4 to E8. The 1/2" drive (for torques over 25Nm) has Allen key bits for 7 - 14mm (short version - 55mm) and 6 - 12mm (long version - 100mm), TORX sockets TX46 - 60 (short version) and external TORX E10 to E18, plus 1.25 - 1.5 - 2.0 - 2.5 and 3mm Allen keys.

See photo for full contents.

NO 23 290

*If you are looking for the best automotive tool set,
don't waste your time looking further.*

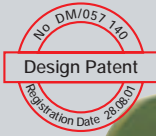

PROXXON
INDUSTRIAL

12 piece matt ring/
open-end CrV steel
spanners.
To DIN 3113.

Sockets and drive elements
made of CrV steel.
To DIN 899.

Switchable ratchet with release mechanism,
made from a single steel billet.

10 YEAR ●
GUARANTEE

Sockets and drive elements carry an additional 25 year guarantee against faulty material and workmanship.

High quality, non-crushable,
impact resistant case made of oil
and acid resistant plastic.

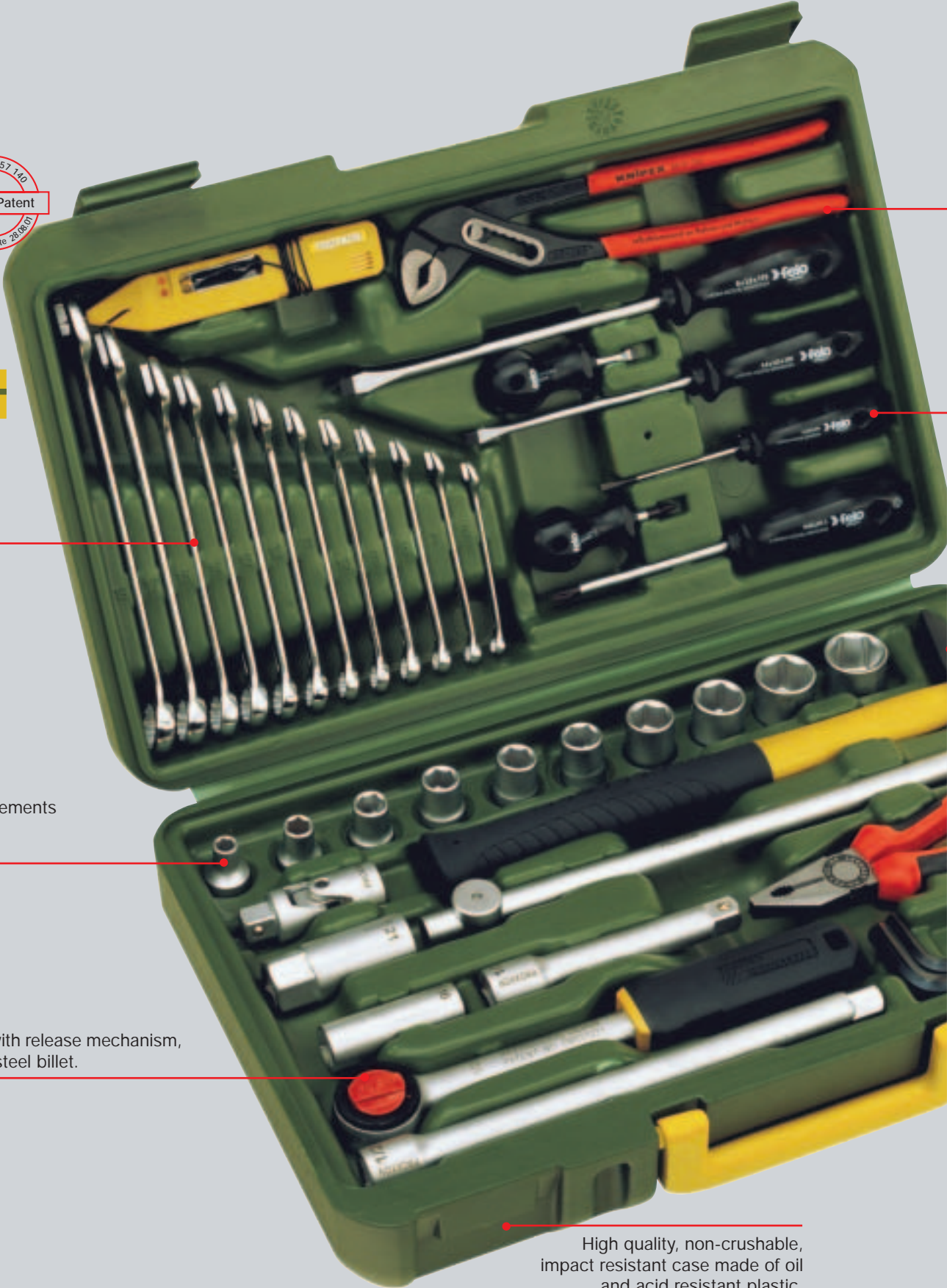



Knipex water pump pliers with through-lock system.

Screwdrivers with ball grip for maximum torque.



Ball-pein hammer (300g), with graphite handle for superior vibration damping, handy non-slip grip.



High quality combination pliers of CrV steel.

Automotive and universal tool set **Practically equipped with first class tools.**

12 piece ring/open-end spanners meet DIN 3113, made of CrV steel, sizes 6 – 15, 17 and 19mm. Knipex 180mm combination pliers and 240mm water pump pliers. Screwdriver set with one each slotted sizes 8.0 x 1.2, 5.5 x 1.0 and 3.0 x 0.5mm and Phillips size 2 as well as two stubby screwdrivers: One Phillips size 2 and slotted screwdriver 5.5 x 1.0mm. Automotive light tester with cable and crocodile clip (for automotive electrical systems only). Sockets, sizes 8 – 10 – 12 – 13 – 14 – 15 – 17 – 19 – 22 and 24mm. Switchable ratchet, universal joint, one each 125 and 250mm extensions. Long T-handle with slide (for loosening plug nuts). Special 16 and 21mm spark plug sockets with ball head on longitudinal side. Allen keys, sizes 5 – 6 – 8 and 10mm. PROXXON ball-pein hammer (300g), ground on all sides and partially polished, inseparable graphite handle (fibre-glass reinforced), non-slip soft coating in holding area) for unparalleled vibration damping.

Specific location for each tool in practical, tough plastic carrying case.

NO 23 650

Universal and oil siphoning pump AP 12. **Perfect for effortless oil changes in 2 – 3 minutes.**

Pumps motor, diesel and heating oil without an effort at 250l/hour when fitted with a 1/2" feed hose. When changing oil with the wand, the flow rate is 3l/min at 40 °C oil temperature. The 200cm 12VDC feed cables are fitted with crocodile clamps. The feed and supply sides are 1/2". A wand of 6mm Ø fits most oil dipstick shafts and is fitted with a reinforced hose. A 1/2" outlet hose of approx. 150cm is supplied. The housing is of glass fibre reinforced POLYAMIDE, approx. 129 x 90 x 90mm. Weight about 1.4kg.

NO 25 262



NOTE:

The wand fits all vehicles with a 6mm oil dipstick shaft.

New 1/4" and 3/8" ROTARY ratchets.

With rotating handle for delicate tightening!

The perfect tool when space is a problem: ideal for heating and cooling systems, motors, exhausts and auto gearboxes.

The rotating handle allows the loosening and tightening of items with just millimetres to spare. Fine tooth drive (52 teeth) ensures normal ratchet function. The socket is ejected by means of a button and this can be matcheted either way. Handy grip of two component material, ergonomically engineered to be used with ease.

- NO 23 082 ROTARY Ratchet 1/4"
- NO 23 083 ROTARY Ratchet 3/8"



The handle is now supplied with a 1/4" square drive hole, so extension(s) may be fitted. A T-handle, if used properly, may also be fitted here. Please note the torques should be limited to 12.5Nm and 27Nm for the 1/4" and 3/8" respectively.

**2 YEAR
GUARANTEE**

For full professional use!

NEW

Extra long bar with universal joint and ratchet capabilities (1/2").

This 43cm long bar allows the loosening of virtually any locked tight item. Made from CrV steel with a matt chrome finish. The robust ratchet mechanism is fine toothed with 60 teeth. The NEOPRENE grip is oil and acid resistant.



NO 23 090

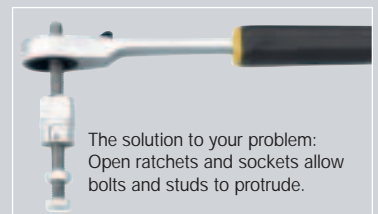

The solution to your problem: Open ratchets and sockets allow bolts and studs to protrude.



Fitting shock absorbers usually requires a 22mm socket.

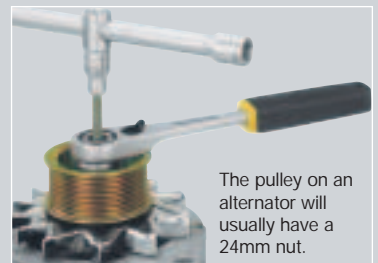

The pulley on an alternator will usually have a 24mm nut.

The new angle ratchet actually works around a corner!

The head may be used normally or swivelled at 45 or 90°.



Side effect::

The loosened head has a side effect that imitates the drive of a steam locomotive.

NEW



Fine toothed

Numerous teeth are engaged simultaneously, transferring huge torques. The changeover mechanism is fitted to the ratchet head and sockets are ejected with the simple push of a button. The shaft and head are made of CrV steel. The handle is made of NEOPRENE and is oil and acid resistant. A hole allows the ratchet to be hung up.

- NO 23 086 1/4", 44 teeth, length 20cm
- NO 23 087 3/8", 60 teeth, length 25cm
- NO 23 088 1/2", 72 teeth, length 32cm

**2 YEAR
GUARANTEE**

For full professional use!

Specialised workshop socket sets. The "open style" ratchet means long bolts protrude through the ratchet and socket.

14 piece set, from 13 to 27mm.

The ratchet has a direction change lever and NEOPRENE handle. The 55mm extension is also of the open style and a 1/2" square adapter is included. The powder coated steel case has a plastic blow moulded bed for tidy storage.

NO 23 604

NEW



13 piece set, from 5.5 to 14mm.

The ratchet has a direction change lever and NEOPRENE handle. The 55mm extension is also of the open style and a 1/4" square adapter is included. The powder coated steel case has a plastic blow moulded bed for tidy storage.

NO 23 602

NEW

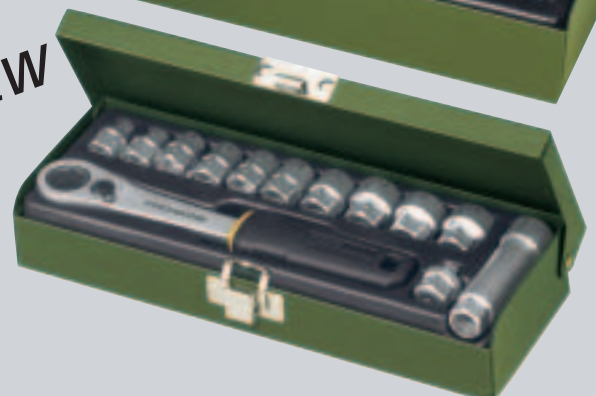

1/4"

Ratchets, sockets and accessories for the delicate

projects. All of chrome vanadium steel 31 CrV 3

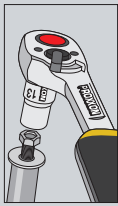

Baton ratchet S (small) 1/4". Our sturdy ratchet!

Fine tooth drive: Many teeth of the 44 teeth engage simultaneously for transferring high torques. Reversing lever for ratcheting direction. Quick-release button for ejecting sockets. Head and shaft forged from one CrV steel billet. Double nickel plated with matt chrome plated finish. Grip of oil and acid resistant NEOPRENE with practical hole for hanging up.

NO 23 330

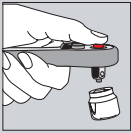

Ratchet 2000 S (small) 1/4". Our extremely flat ratchet!

Precision ratchet drive for long service life and high torque transmission. Reversing lever for ratcheting direction. Quick-release button for releasing sockets instantly. With handy, soft-touch DuPont HYTREL grip and practical hole for hanging up.

NO 23 170

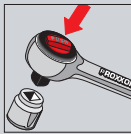

Standard ratchet S (small) 1/4". Proven 100,000 times over!

With reversing feature directly on ratchet mechanism. Many of the 44 teeth engage simultaneously for transferring extremely high torques. Quick-release button for ejecting sockets instantly. Head and shaft forged from one piece of CrV steel. Double nickel plated with matt chrome plated finish. Grip of oil and acid resistant NEOPRENE with practical hole for hanging up.

NO 23 092

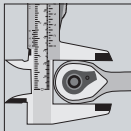

MICRO ratchet S (small) 1/4". The slender ratchet with fine teeth!

With extremely small head and 60 ratchet teeth, yielding the perfect fine-tooth drive for ratcheting action even when turned only 6°. Reversing lever for changing ratcheting direction. Quick-release button releases socket instantly. Head and shaft forged from one piece of CrV steel. Double nickel plated with matt chrome plated finish.

NO 23 164



MICRO ratchet 1/4"

The head is extremely small at 19mm Ø and may be swivelled and locked in 14 positions through 45°. This allows working in normally inaccessible and around the corner spots in cars for example. Extremely fine-toothed at 72 teeth with several teeth engaging simultaneously allowing the ratchet to operate in spaces where it can rotate only 6 degrees. With one finger reversing lever for ratcheting direction, and push button socket ejection. Matt chrome-plated finish.

NO 23 162



MICRO flex head ratchet 1/4"

The six sided ring accepts standard 1/4" bits. Distance from direction change lever to bit tip is only 35mm. Other details as above.

NO 23 158



The correct tool for really tight spots!



1/4" screwdriver handle square drive and hole in handle, 140mm long.

Size Part NO

23 702



1/4" magnetic holder for hexagonal bits with male and female hex. shafts. Ideal for working with electric screwdrivers and drills.

23 703



1/4" T-bar with slide

23 704



1/4" extension

50mm 23 707
100mm 23 708
150mm 23 705

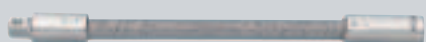

1/4" flexible extension

150mm 23 706

	Size	Part NO
		23 709
	1	23 780
(DIN 3126) female square to female hexagon		
	2	23 782
1/4" female square to 3/8" male square		
	3	23 701
1/4" female square to 1/4" male hexagon.		
	4mm	23 710
	4.5mm	23 711
	5mm	23 712
	5.5mm	23 713
	6mm	23 714
	6.5mm	23 715
	7mm	23 716
	8mm	23 718
	9mm	23 720
	10mm	23 722
	11mm	23 724
	12mm	23 726
	13mm	23 728
	14mm	23 729
	4mm	23 767
For long protruding bolts.		
	5mm	23 768
	5.5mm	23 769
	6mm	23 770
	7mm	23 772
	8mm	23 774
	9mm	23 776
	10mm	23 778
	11mm	23 777
	12mm	23 775
	13mm	23 779
	14mm	23 773
	SW 2mm	23 744
Head made of chrome silicon manganese molybdenum steel.		
	SW 2.5mm	23 746
Socket CrV steel.		
	SW 3mm	23 743
	SW 4mm	23 745
	SW 5mm	23 747
	SW 6mm	23 749
	SW 8mm	23 751
	E 4	23 788
	E 5	23 790
	E 6	23 792
	E 8	23 794
	E 10	23 796
	TX 6	23 752
Head made of chrome silicon manganese molybdenum steel. Socket CrV steel.		
	TX 8	23 753
	TX 10	23 754
	TX 15	23 756
	TX 20	23 758
	TX 25	23 760
	TX 27	23 761
	TX 30	23 762
	TX 40	23 764
	4mm	23 737
Made of chrome silicon manganese molybdenum steel. Socket CrV steel.		
	5.5mm	23 739
	7mm	23 741
	8mm	23 742
	No 1	23 730
Made of chrome silicon manganese molybdenum steel. Socket CrV steel.		
	No 2	23 731
	No 3	23 732
	No 1	23 733
Made of chrome silicon manganese molybdenum steel. Socket CrV steel.		
	No 2	23 735

3/8"

Ratchets, sockets and accessories, handy and compact

for every user! 31 CrV 3 chrome-vanadium steel.

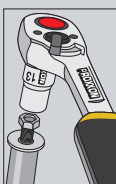

Baton ratchet M (medium) 3/8". Our sturdy ratchet!

Fine tooth drive: Many of the 52 teeth engage simultaneously for transferring maximum torque. Reversing lever for ratcheting direction. Quick-release button for releasing sockets instantly. Head and shaft forged from one piece of CrV steel. Double nickel-plated with matt chrome-plated finish. Grip of oil and acid resistant NEOPRENE with practical hole for hanging up.

NO 23 332

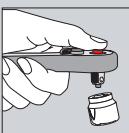

Ratchet 2000 M (medium) 3/8". Our extremely flexible ratchet!

Precision ratchet drive with 44 teeth for long service life and high torque. Reversing lever for ratcheting direction. Quick-release button for releasing sockets instantly. With handy, soft-touch DuPont HYTREL grip and practical hole for hanging up.

NO 23 180

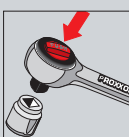

Standard ratchet M (medium) 3/8". Proven 100,000 times over!

With reversing feature directly on ratchet mechanism. Many of the 44 teeth engage simultaneously for transferring extremely high torque. Quick-release button for releasing sockets instantly. Head and shaft forged from one piece of CrV steel. Double nickel-plated with matt chrome-plated finish. Grip of oil and acid resistant NEOPRENE with practical hole for hanging up.

NO 23 094

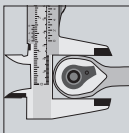

MICRO ratchet M (medium) 3/8". The slender ratchet with fine teeth!

With an extremely small head. The 60 tooth drive allows a perfect ratcheting action even when turned only 6°. Reversing lever for changing ratcheting direction. Quick-release button releases socket instantly. Head and shaft forged from one piece of CrV steel. Double nickel-plated with matt chrome-plated finish.

NO 23 166



3/8" extension with slide
Adapter to 3/8" male square and 1/2" female square.

Size Part NO

200mm 23 558

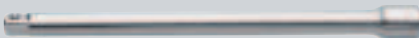

3/8" extension

75mm 23 554
150mm 23 556



3/8" universal joint

23 560



3/8" adapter
3/8" female to 1/4" male square (slide for 1/4" extension).

23 564



3/8" adapter
3/8" female square drive to male 1/2" drive (slide for 1/2" extension).

23 566



3/8" spark plug socket
With NEOPRENE insert for holding spark plugs.

16mm 23 550
18mm 23 551
21mm 23 552



3/8" sockets

Size	Part NO
6mm	23 500
7mm	23 502
8mm	23 504
9 mm	23 506
10mm	23 508
11mm	23 510
12mm	23 512
13mm	23 514
14mm	23 516
15mm	23 518
16mm	23 520
17mm	23 522
18mm	23 523
19mm	23 524
21mm	23 526
22mm	23 528
24mm	23 530



**3/8" deep sockets
for protruding bolts**

8mm	23 532
9mm	23 534
10mm	23 536
11mm	23 538
12mm	23 540
13mm	23 542
14mm	23 543
15mm	23 544
17mm	23 546
18mm	23 548
19mm	23 549
22mm	23 545
24mm	23 547



3/8" Allen sockets – 80mm

Allen key made of chrome-silicon-manganese-molybdenum steel. Socket CrV steel.

SW	4mm	23 575
SW	5mm	23 576
SW	6mm	23 578
SW	7mm	23 579
SW	8mm	23 580
SW	10mm	23 581



3/8" TORX

Head made of chrome-silicon-manganese-molybdenum steel. Socket CrV steel.

TX 10	23 583
TX 20	23 584
TX 25	23 585
TX 27	23 586
TX 30	23 587
TX 40	23 588
TX 45	23 589
TX 50	23 590



3/8" flat screwdriver bit

Bit made of chrome-silicon-manganese-molybdenum steel. Socket CrV steel.

4mm	23 591
5.5mm	23 592
8mm	23 593

3/8" Phillips screwdriver bit

Bit made of chrome-silicon-manganese-molybdenum steel. Socket CrV steel.

No 1	23 594
No 2	23 595
No 3	23 596



PROXXON have been producing fine power tools for about 30 years. Let us forward you our full 56 page catalogue free of charge.

There are more than 50 different tools in our range from the MICRO Engraving Pen GG 12, to our precision engineering lathe PD400.

PROXXON GmbH
D-54518 Niersbach/Eifel

export@proxxon.com



1/2"

Ratchets, sockets and accessories for the most

demanding situations. 31 CrV 3 chrome-vanadium steel.

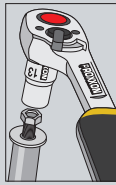

Baton ratchet L (large) 1/2". Our sturdy ratchet!

Fine tooth drive: Many of the 52 teeth engage simultaneously for transferring maximum torque. Reversing lever for ratcheting direction. Quick-release button for releasing sockets instantly. Head and shaft forged from one piece of CrV steel. Double nickel-plated with matt chrome-plated finish. Grip of oil and acid resistant NEOPRENE with practical hole for hanging up.

NO 23 334

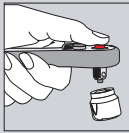

Ratchet 2000 L (large) 1/2". Our extremely flexible ratchet!

Precision ratchet drive with 44 teeth for long service life and high torque transmission. Reversing lever for ratcheting direction. Quick-release button for releasing sockets instantly. With handy, soft-touch DuPont HYTREL grip and practical hole for hanging up.

NO 23 190



Standard ratchet L (large) 1/2". Proven 100,000 times over!

With reversing feature directly on ratchet mechanism. Many of the 44 teeth engage simultaneously for transferring extremely high torque. Quick-release button for releasing sockets instantly. Head and shaft forged from one piece of CrV steel. Double nickel-plated with matt chrome-plated finish. Grip of oil and acid resistant NEOPRENE with practical hole for hanging up.

NO 23 096

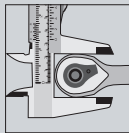

MICRO ratchet L (large) 1/2". The slender ratchet with fine teeth!

With an extremely small head. Perfect fine-tooth drive with 60 teeth for ratcheting action even when turned only 6°. Reversing lever for changing ratcheting direction. Quick-release button releases socket instantly. Head and shaft forged from one piece of CrV steel. Double nickel-plated with matt chrome-plated finish.

NO 23 168



1/2" T-bar extension
With adapter from 1/2" male to 3/8" female.

Size Part
NO

250mm 23 457



1/2" extension

64mm 23 452
125mm 23 454
250mm 23 456



1/2" female to 3/8" male square drive
(slide for 3/8" extension).

23 458



1/2" universal joint

23 450



1/2" spark plug socket
With NEOPRENE insert for holding spark plugs.

16mm 23 442
18mm 23 443
19mm 23 445
21mm 23 444



1/2" spark plug socket with magnetic insert
A powerful permanent magnet facilitates attachment and holds the spark plug tightly.

16mm 23 392
18mm 23 394
21mm 23 396



1/2" slotted screw bit, 55mm
Chrome-silicon-manganese-molybdenum steel. CrV steel socket.

8mm 23 462
10mm 23 464

1/2" Phillips screw bit, 55mm
Chrome-silicon-manganese-molybdenum steel. CrV steel socket.

No 2 23 470
No 3 23 472
No 4 23 474



1/2" socket
With reduced drive and diameter
(19mm and over).

Size	Part NO
8mm	23 400
9mm	23 402
10mm	23 404
11mm	23 406
12mm	23 408
13mm	23 410
14mm	23 412
15mm	23 414
16mm	23 415
17mm	23 416
18mm	23 417
19mm	23 418
21mm	23 420
22mm	23 422
23mm	23 423
24mm	23 424
27mm	23 426
30mm	23 428
32mm	23 430
34mm	23 431
36mm	23 429



1/2" deep sockets
For protruding bolts.

10mm	23 355
11mm	23 356
12mm	23 357
13mm	23 358
14mm	23 359
15mm	23 360
16mm	23 361
17mm	23 362
18mm	23 363
19mm	23 364
21mm	23 365
22mm	23 366
24mm	23 367

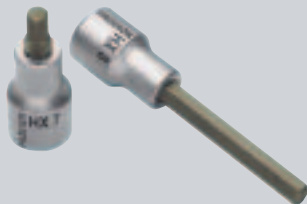

1/2" Allen sockets (55mm)
Allen key made of chrome-silicon-
manganese-molybdenum steel.
Socket CrV steel.

SW 5mm	23 476
SW 6mm	23 477
SW 7mm	23 478
SW 8mm	23 479
SW 10mm	23 480
SW 12mm	23 481
SW 14mm	23 482

1/2" Allen sockets (100mm)
Allen key made of chrome-silicon-
manganese-molybdenum steel.
Socket CrV steel.

SW 5mm	23 484
SW 6mm	23 475
SW 7mm	23 485
SW 8mm	23 486
SW 10mm	23 487
SW 12mm	23 483

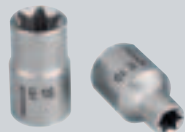

1/2" external TORX sockets

E 10	23 380
E 12	23 382
E 14	23 384
E 18	23 388

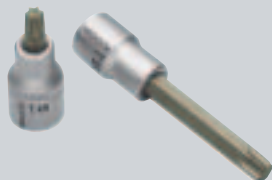

1/2" TORX socket (55mm)
Head made of chrome-silicon-manganese-
molybdenum steel. Socket CrV steel.

TX 20	23 488
TX 25	23 489
TX 27	23 490
TX 30	23 491
TX 40	23 492
TX 45	23 493
TX 50	23 494
TX 55	23 446
TX 60	23 447

1/2" TORX socket (100mm)
Head made of chrome-silicon-manganese-
molybdenum steel. Socket CrV steel.

TX 40	23 495
TX 45	23 496
TX 50	23 497
TX 55	23 498
TX 60	23 499



1/2" multi-toothed socket (100mm)
for XZN bolts. Bit made of chrome-silicon-
manganese-molybdenum steel. Socket CrV
steel.

VZ 6	23 370
VZ 8	23 371
VZ 10	23 372
VZ 12	23 373
VZ 14	23 374

MICRO-Click torque wrenches with ratchet feature and

High accuracy of +/- 3% conforms with DIN/ISO.

**2 YEAR
GUARANTEE**

For full professional use!

Large, clearly legible scale for exact adjustment of desired torque by turning knurled adjustment ring on end of handle.

Ratchet mechanism with reversing lever for changing ratcheting direction. Automatic quick release: Clearly audible and perceptible "click" upon reaching set torque.

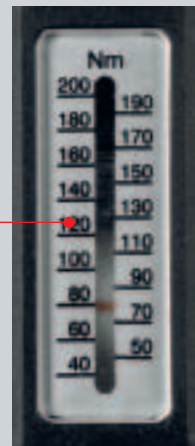

MICRO-Click 30/S Torque Wrench

With 1/4" square drive to DIN 3120. For torques from 5 to 30Nm. For tightening all types of bolts up to M8 (13mm head). Otherwise as described above.

NO 23 349

MICRO-Click 100/S Torque Wrench

With 3/8" square drive to DIN 3120 (convertible for left-hand threads). For torques from 20 to 100Nm. Otherwise as described above.

NO 23 351

MICRO-Click 200/S Torque Wrench

With 1/2" square drive to DIN 3120 (convertible for left-hand threads). For torques from 40 to 200Nm. Otherwise as described above.

NO 23 353



Torque can be set by turning the knurled ring at the end of the handle. Push in ring to lock in position.





MICRO-Click torque wrenches are precision tools. They are packaged in sturdy and practical plastic storage box.

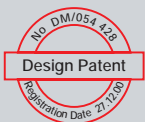

Tightening torques for bolt shanks with standard metric threads (DIN 13, Part 13) and head contact dimensions (DIN 912, 931, 934). The coefficient of friction was determined using an untreated and unplated bolt (ungreased, lightly oiled).

MM	HEX	INHEX	FM-TX	M-TX	Nm
M 1,6	3,2	SW 1,5			-
M 2	4	SW 2	TX 6		-
2 - 2,5			TX 7		
M 2,5	5	SW 2	TX 8		-
2,9 - 3			TX 9		
M 3	5,5	SW 2,5	TX 10	E 4	-
(M 3,5)	6	-	TX 15		-
M 4	7	SW 3	TX 20	E 5	3
M 5	8	SW 4	TX 25	E 6	5,9
4,5 - 6			TX 27		
M 6	10	SW 5	TX 30	E 8	10
(M 7)	11	-	TX 40		-
M 8	13	SW 6	TX 40	E 10	25
8-10			TX 45		
M 10	(16) 17	SW 8	TX 50	E 12	49
M 12	(18) 19	SW 10	TX 55	E 14	85
(M 14)	(21) 22	SW 12	TX 60	E 18	135
M 16	24	SW 14	TX 70	E 20	210
(M 18)	27	SW 14	TX 80	E 24	300
M 20	30	SW 17	TX 90	E 24	425
(M 22)	(34) 32	-			580
M 24	36	SW 19			740

© by PROXXON



MICRO-Click Torque Screwdriver For precisely torquing screws between 1 and 5Nm.

Clearly audible and detectable "click" when the selected torque is reached. High repeatability with 6% accuracy. The scale is clear and easy to read. Standard 1/4" bits are clamped in a spring release chuck.

A hex to square adapter is included.

The kit is supplied in a sturdy plastic case.

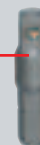

NEW

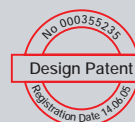

NO 23 347

Super Safety and Special Bit Set.

Nothing is Impossible to Unscrew.

**2 YEAR
GUARANTEE**

Bits and adapters carry an additional 25 year guarantee against faulty material and workmanship!

For full professional use!

Deep hole bits (80 mm)
Normal bits (25 mm)

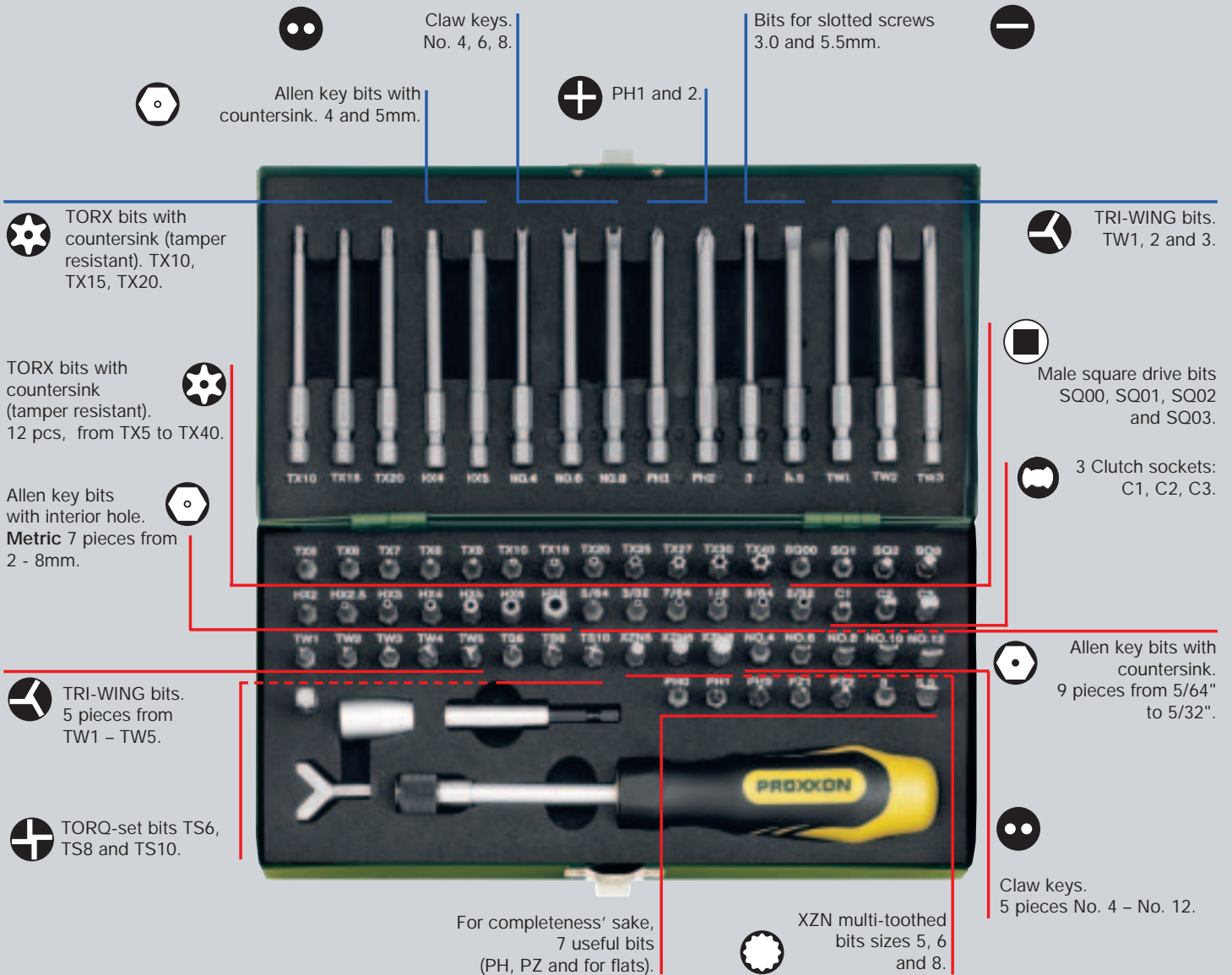

Super safety and specialty bit set, 1/4" drive. 75-piece.

Industrial quality tool set of special chrome-molybdenum-silicon-manganese-vanadium steel alloy. Sizes and shapes as described above. Including screwdriver with positive spring-sleeve holder for bits. Magnetic holder for work with electric screwdriver or drill. Adapter with male square and male hex drive and matching attachment with female square and female hex drive. Special

attachment for centrally clamping screw hooks and similar parts. All in sturdy steel box with durable powder coated finish. Each part clearly marked and of fixed location.

NO 23 107



Allen and TORX keys for highest torques.



Nine piece Allen key set with spherical finish on the long end.

One each 1.5 – 2.0 – 2.5 – 3.0 – 4.0 – 5.0 – 6.0 – 8.0 and 10mm. Chrome-vanadium steel. In foldable plastic holder.

NO 23 946

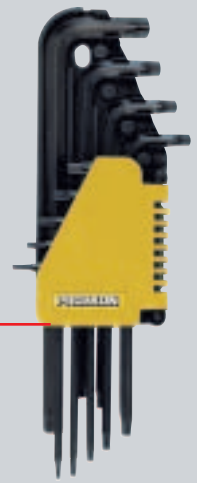

Nine piece TORX set.

One each TX 8 – 10 – 15 – 20 – 25 – 27 – 30 – 40 – and 50. Made from Nickel-Chrome-Molybdenum special steel. In foldable plastic holder.

NO 23 944

Pocket Allen key set, 8 piece.

One each 1.5 – 2.0 – 2.5 – 3.0 – 4.0 – 5.0 – 6.0 – 8.0 and 10mm. Made from Chrome-Molybdenum special steel, galvanically plated. In pocket knife type plastic holder which also serves as a handle.

NO 23 956

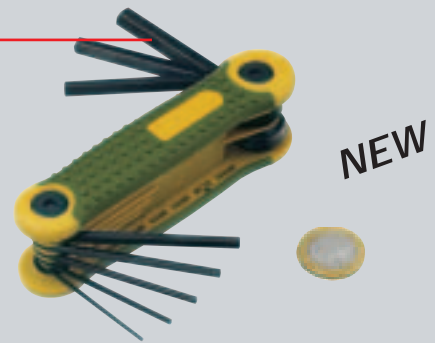
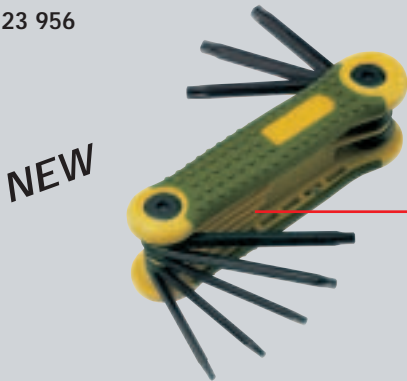

Pocket TORX key set, 8 piece.

One each TX 9 – 10 – 15 – 20 – 25 – 27 and 30. Made from Nickel-Chrome-Molybdenum special steel. In pocket knife type plastic holder which also serves as a handle.

NO 23 954

SPEEDER ratchet spanners with reversing mechanism. Reverse without turning over, easy, handy and economical!

SPEEDER set for hex head bolts. Spanners from 6 – 19mm.

Sizes 6x7, 8x9, 10x11, 12x13, 14x15 and 17x19mm. The set comes in a powder coated sturdy steel carry case.

NO 23 231

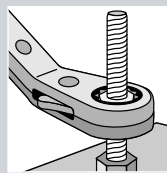

Gap allows long bolts to pass through when tightening the nut.

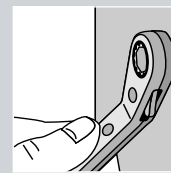

Head offset 25° for advantageous handling.

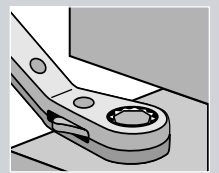

The SPEEDER shows its strengths in close quarters.



**DIN
ISO**

SPEEDER ratchet spanners (loose).

NO 23 201	Size	6 x 7
NO 23 204	Size	8 x 9
NO 23 205	Size	10 x 11
NO 23 207	Size	10 x 13
NO 23 209	Size	12 x 13
NO 23 211	Size	14 x 15
NO 23 214	Size	16 x 18
NO 23 215	Size	17 x 19
NO 23 216	Size	19 x 21

**2 YEAR
GUARANTEE**

For full professional use!

MICRO-Speeder in a new longer version.

Superb tools with modern technology.

PROXXON
INDUSTRIAL

2 YEAR ●
GUARANTEE

For full professional use!

Old generation spanners cannot be repositioned: here the Speeder's ratchet function takes over.

The 72-tooth inner ring gear, made of special high alloy steel, allows ratcheting even when the spanner can only be moved through 5°. Nevertheless, the torque transfer capacity far exceeds the DIN/ISO standards and this enables the longer design. CrV steel shaft, chrome-plated, with a satin finish to pamper your hands. Clear, laser inscribed sizes avoid any confusion.



The fully encapsulated drive is perfectly functional.



The extremely compact exterior measurements (A+B) and very slender head offer superior accessibility.



The MICRO-Combispeeder of long design offers a lever for direction change, 15° ring offset and Cap Stop technology (see description below).



The 15° ring offset might make the turning over of the spanner impossible. For this instance, the direction change lever solves the problem. The spanner is ideally suited for working on flat surfaces, especially useful with the cap stop feature, see below.

MICRO Combispeeder set, 6-piece

One each 10 – 13 – 16 – 17 – 18 and 19mm in a sturdy powder coated steel box.

NO 23 124



NO 23 130	Size 8
NO 23 131	Size 9
NO 23 132	Size 10
NO 23 133	Size 11
NO 23 134	Size 12
NO 23 135	Size 13
NO 23 136	Size 14
NO 23 137	Size 15
NO 23 138	Size 16
NO 23 139	Size 17
NO 23 140	Size 18
NO 23 141	Size 19
NO 23 143	Size 21
NO 23 144	Size 22
NO 23 146	Size 24



The Cap Stop technology:
The Combispeeder flange prevents the spanner from dropping past the nut.

No swopping over of the spanner: a real time saver.

MICRO-Speeder with straight, slender and extra long design. Ideal for inserting into tight spaces.



When things get really tight, the MICRO Combispeeder is superior. Often used on automatic transmissions for removing engines, on rear axles, etc. Mechanics often carry the sizes 10 x 13 and 17 x 19 with them.

NO 23 241	Size 8 x 9
NO 23 243	Size 10 x 11
NO 23 244	Size 10 x 13
NO 23 246	Size 12 x 13
NO 23 247	Size 14 x 15

NO 23 249	Size 16 x 18
NO 23 250	Size 17 x 19
NO 23 252	Size 22 x 24
NO 23 254	Size 27 x 30
NO 23 255	Size 32 x 34

MICRO-Combispeeder of extra long design with swivelling ring action of up to 90°.

NEW



The self positioning action of the ring means extreme ease of use, even after being used many times over. The spanner's flexibility remains unmatched. The self positioning action of the ring is ideal for tight locations.

NO 23 045	Size 8mm
NO 23 046	Size 9mm
NO 23 047	Size 10mm
NO 23 048	Size 11mm
NO 23 049	Size 12mm
NO 23 050	Size 13mm
NO 23 051	Size 14mm
NO 23 052	Size 15mm
NO 23 053	Size 16mm
NO 23 054	Size 17mm
NO 23 055	Size 18mm
NO 23 056	Size 19mm
NO 23 058	Size 21mm
NO 23 059	Size 22mm
NO 23 061	Size 24mm

MICRO-Combispeeder 6 piece set with self-positioning ring end.

One each 10, 13, 16, 17, 18 and 19mm of the long version, in a sturdy powder coated steel box.

NO 23 068



NEW



*Inversible joint:
Unbeatable in tight places!*

Slim-Line - spanners – Tools to get to grips with.

- Polished heads: slim and thin walled. Torque characteristics still exceed DIN/ISO requirements.
- Easy to hold, smooth finish without sharp edges and sides.
- Dimensional tolerances are better than those required by DIN/ISO. Each piece is calibrated and checked.
- Optimal surface protection against rust by means of double nickel and subsequent chrome plating.

Slim-Line - open-end spanners: 8 piece set complete with holder. To DIN 3110 and ISO 3318.

Includes 6 x 7, 8 x 9, 10 x 11, 12 x 13, 14 x 15, 16 x 17, 18 x 19 and 20 x 22mm.
Supplied with a plastic holder with slot for each spanner and holes for attaching to a wall. All spanners clearly labelled to make them easy to find.

NO 23 800 as above



PROXION INDUSTRIAL		open-end spanner				
S ₁ x S ₂	B ₁	B ₂	L	H		
23 828	5 x 5,5 mm	13	14	111	3	
23 830	6 x 7 mm	16	18	123	3,4	
23 832	8 x 9 mm	20	22	145	3,5	
23 834	10 x 11 mm	24	26	157	4,0	
23 836	12 x 13 mm	28	29	173	4,7	
23 838	10 x 13 mm	24	29	174	4,7	
23 840	14 x 15 mm	32	34	190	5,0	
23 842	16 x 17 mm	36	38	205	5,2	
23 846	18 x 19 mm	38	42	220	5,7	
23 848	17 x 19 mm	33	42	220	5,7	
23 850	20 x 22 mm	43	46	235	6,5	
23 852	21 x 23 mm	45	48	248	6,5	
23 856	24 x 27 mm	49	55	268	6,5	
23 860	30 x 32 mm	59	64	302	9,0	
23 864	34 x 36 mm	65	79	320	10,0	
23 866	41 x 46 mm	86	95	415	15,0	



The 15 piece super set includes the new ISO sizes 16, 18 and 22mm

Slim-Line - combination spanners. Fifteen piece set complete with holder. To DIN 3113 and ISO 3318. Ring head offset 15°.

Sizes 6 – 7 – 8 – 9 – 10 – 11 – 12 – 13 – 14 – 15 – 16 – 17 – 18 – 19 – 21mm. Plastic holder with slot for each spanner and holes for attaching to a wall. All spanners clearly labelled to make them easy to find.

NO 23 821 as above

Slim-Line - combination spanners. Twelve piece set with 15° offset heads.

Sizes 6 – 7 – 8 – 9 – 10 – 11 – 12 – 13 – 14 – 15 – 17 – 18 and 19mm. Otherwise as detailed on the left.

NO 23 820 as above

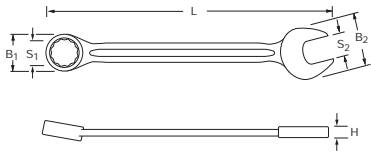
	PROXXON INDUSTRIAL combination spanners				
	S ₁	B ₁	B ₂	L	H
23 905	5,5 mm	9	14	93	3
23 906	6 mm	10	16	100	3,4
23 907	7 mm	12	18	110	3,5
23 908	8 mm	13	20	120	3,5
23 909	9 mm	15	22	130	3,5
23 910	10 mm	16	23	140	4,0
23 911	11 mm	17	25	150	4,7
23 912	12 mm	19	27	160	4,7
23 913	13 mm	20	28	170	5,0
23 914	14 mm	22	31	180	5,0
23 915	15 mm	24	34	190	5,2
23 916	16 mm	25	36	195	5,2
23 917	17 mm	25	38	210	5,2
23 918	18 mm	28	39	216	6,5
23 919	19 mm	28	42	230	6,5
23 920	20 mm	30	45	250	6,5
23 921	21 mm	32	46	245	6,5
23 922	22 mm	33	49	270	6,5
23 924	24 mm	36	51	280	6,5
23 927	27 mm	39	55	310	7,7
23 930	30 mm	44	59	340	9,0
23 932	32 mm	46	64	360	9,0



CrV drop forged, carefully hardened and plated.

**10 YEAR
GUARANTEE**

For full professional use!



Each spanner has a clearly marked place for storage. The plastic holder also offers holes to allow it to be fixed to a wall.

**Slim-Line - Double ring spanner set:
Eight piece set. To DIN 838 and ISO 3318 with 75° offset heads.**

Sizes 6 x 7, 8 x 9, 10 x 11, 12 x 13, 14 x 15, 16 x 17, 18 x 19 and 20 x 22mm.

Each spanner has a clearly marked place for storage. The plastic holder also offers holes to allow it to be fixed to a wall.

NO 23 810 set complete

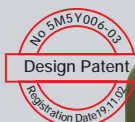

PROXXON INDUSTRIAL		double ring spanner			
	S ₁ x S ₂	B ₁	B ₂	L	H
23 868	5 x 5,5 mm	9	10	162	5
23 870	6 x 7 mm	10	12	173	5,6
23 872	8 x 9 mm	13	14	182	6,1
23 874	10 x 11 mm	16	17	200	7,9
23 876	12 x 13 mm	18	19	212	8,5
23 878	10 x 13 mm	16	19	212	8,5
23 880	14 x 15 mm	21	23	225	9,8
23 882	16 x 17 mm	24	25	245	10,4
23 886	18 x 19 mm	27	28	260	11,3
23 888	17 x 19 mm	25	28	216	11,3
23 890	20 x 22 mm	30	32	285	12,8
23 892	21 x 23 mm	31	33	310	12,9
23 896	24 x 27 mm	34	38	335	13,9
23 900	30 x 32 mm	42	45	375	15,3



Slim-Line-Spanners for Trade and Industry.



**10 YEAR
GUARANTEE**

For full professional use!

Polished heads, slim and thin walled, yet exceeding the DIN/ISO standards by far. Easy to hold, smooth finish without sharp edges and sides.

- Easy to grip and to hold shaft with skin friendly surface (Satin-finish). No sharp edges or sides.
- Dimensional tolerances better than those required by DIN/ISO. Each piece is calibrated and checked.
- Optimal surface protection against rust using double nickel and subsequent chrome plating.



Slim-Line-open-end spanners. Eleven piece set to DIN 3110 and ISO 3318.

Sizes 6 x 7, 8 x 9, 10 x 11, 12 x 13, 14 x 15, 16 x 17, 18 x 19, 20 x 22, 21 x 23, 24 x 27 and 30 x 32mm.

All supplied in a cardboard box.

NO 23 802

Slim-Line-combination spanners. Twenty-one piece set to DIN 3113 and ISO 3318. Ring head offset 15°.

Sizes 6 – 7 – 8 – 9 – 10 – 11– 12 – 13 – 14 – 15 – 16 – 17– 18 – 19 – 20 – 21 – 22 – 24 – 27 – 30 and 32mm.

All supplied in a cardboard box.

NO 23 822

Slim-Line-double ring spanners. Eleven piece set to DIN 838 and ISO 3318. With 75° offset heads.

Sizes 6 x 7, 8 x 9, 10 x 11, 12 x 13, 14 x 15, 16 x 17, 18 x 19, 20 x 22, 21 x 23, 24 x 27 and 30 x 32mm.

All supplied in a cardboard box.

NO 23 812

NOTE

The last page of this catalogue depicts the new IMPACT sockets, ideal for use on sensitive aluminium alloy wheels.

IMPACT socket set. For use with compressed air impact tools (1/2"). 24 pieces.



Forged from top quality chrome, molybdenum, nickel and manganese alloy for superior wear resistance and maximum torque up to 500Nm.

Complete contents: 10, 12, 13, 14, 15, 16, 17, 18, 19, 21, 22 and 24mm standard sockets (38mm long) as well as deep sockets (78mm). The doubling of the lengths avoids the use of extensions.

In sturdy, powder coated steel case.

NO 23 942



NEW

Our new 1/2" drive IMPACT sockets, ideal for use on delicate aluminium alloy wheels.



Plastic mantle and insert prevent from damaging the delicate alloy wheels. Ideal for tyre and auto workshops.

One each of 17, 19 and 21 of 85mm length are supplied in a powder coated sheet steel box. The chrome, molybdenum, nickel and manganese alloy ensures maximum wear resistance and torque capabilities up to 500Nm.
In sturdy, powder coated steel case.

NO 23 938

PROXXON GmbH
Im Spanischen 18 – 24 • D-54518 Niersbach/Eifel
Tel. +49 (0) 65 75-78-0 • Fax +49 (0) 65 75-78-105
email export@proxxon.com • www.proxxon.com